

A&N Model Trucks



Aussie Argosy truck
(1st generation)
Conversion kit, 1/24

Made in Latvia

Warning!

For the best results we highly suggest to use our photo-etched chassis for Aussie Argosy truck. But you still can use an Italeri's generic American chassis (except Volvo VN and Peterbilts).

Read carefully this instruction and please follow it during assembling, otherwise you could face problems with assembling the model.

Photo-etched parts have sharp edges, please be careful.

This model kit contains very small parts and is not suitable for children.

This model kit is for advanced modellers only!

You can download this instruction as PDF-file at the our site at «Instructions» section, or use QR-code on the last page.

Symbols:

 - glue parts;

 - do not glue parts;

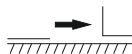
 - bend parts;

 - attention;

 - moving parts;

 - your choice;

 - cut;

! Basic guidelines for modification of Italeri's chassis

(skip this section and jump on page 7 if you use photo-etched chassis).

WARNING! We didn't test our cab kits with Italeri chassis, we can provide only basic dimensions (in mm) for chassis.

1. Frame length.

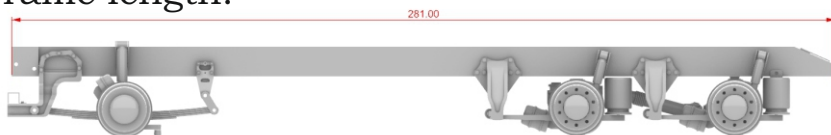

2. Wheelbase and distance between center of front wheels and front end of a frame

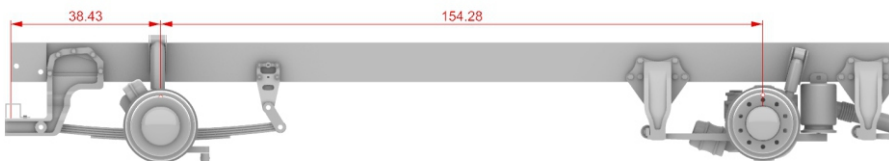

3. Dimensions for front suspension.

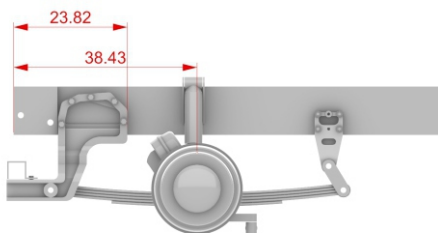

4. Installing front cab's supports.

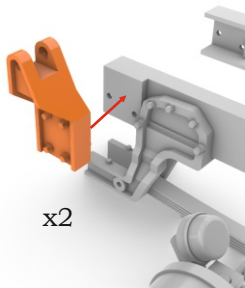

5. Max height of radiator.

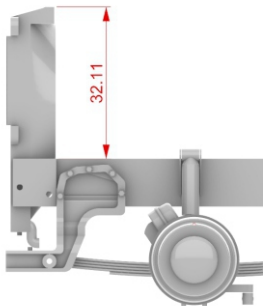

6. Distance between front end of frame and rear cab's supports.

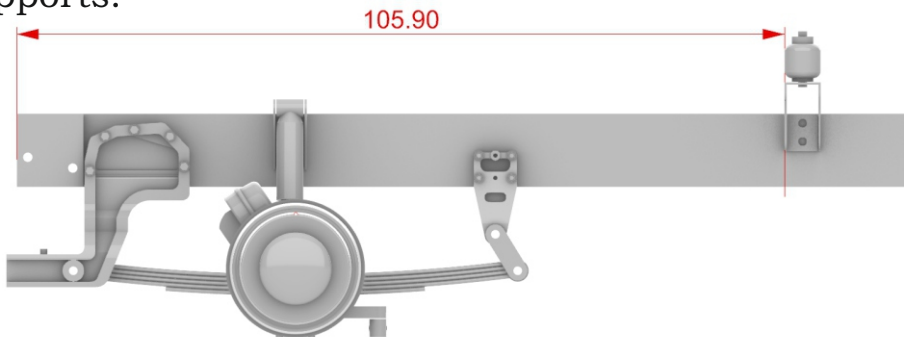

7. Distance between front end of frame and front end of fuel tanks.

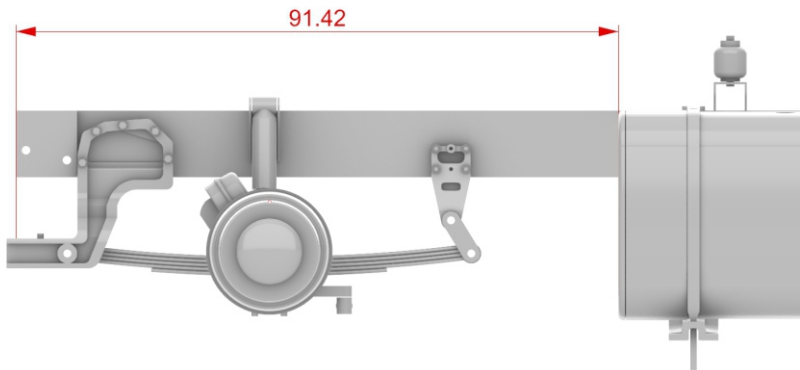

8. Distance between front end of frame and front end of battery box.

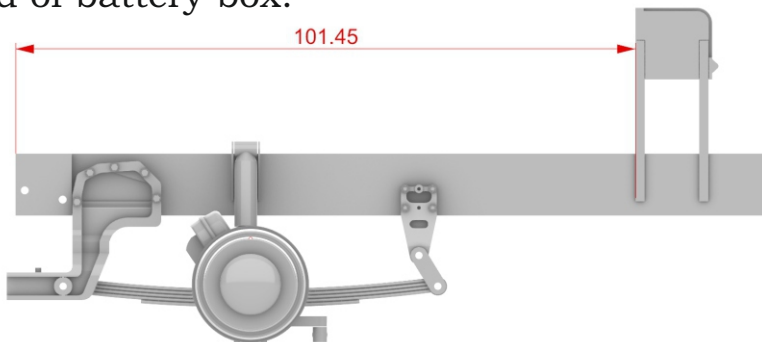

9. Distance between front end of frame and silencer's brackets.

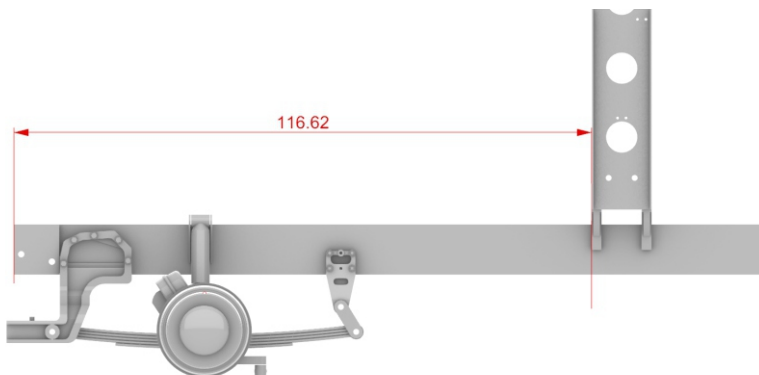

Main section

1. 

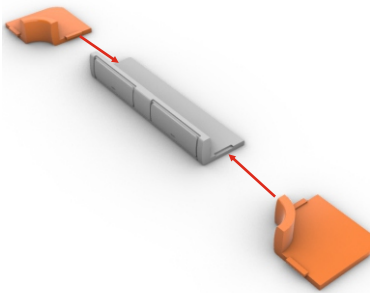

2.  x2

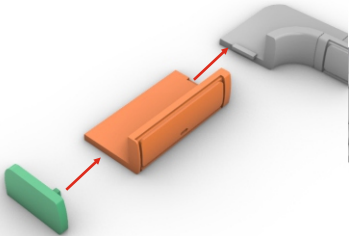

3. 

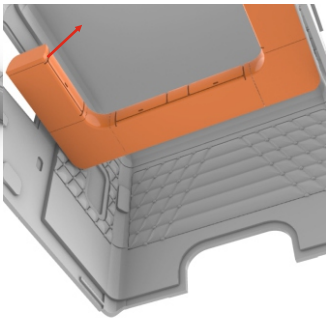



4.  x2

PE-part #15

5.  x2

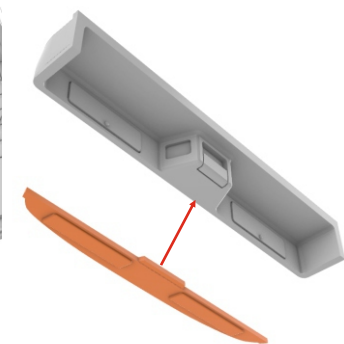
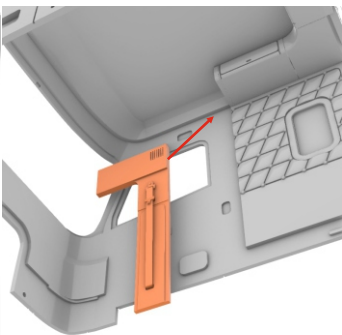
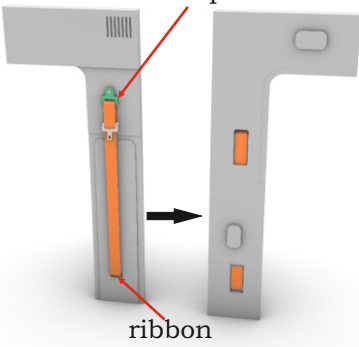
6. 



7.  PE-part #8

8. 

9. 

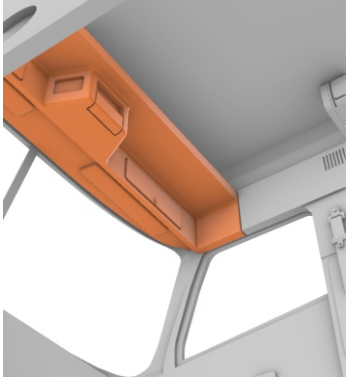
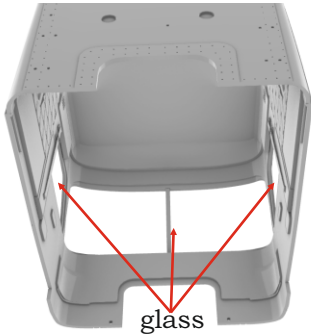

10.  x2

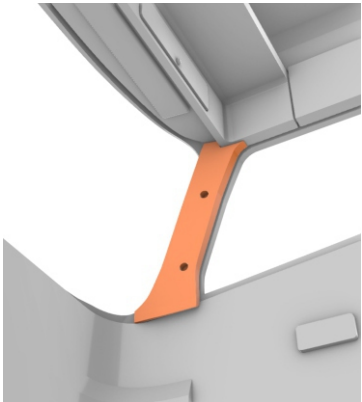

11.  x2

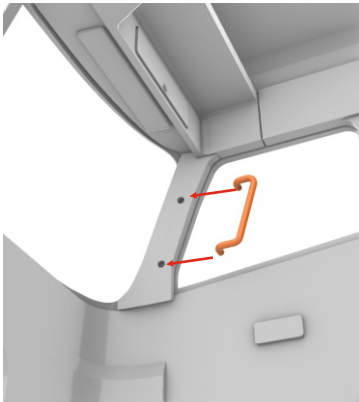

12. 

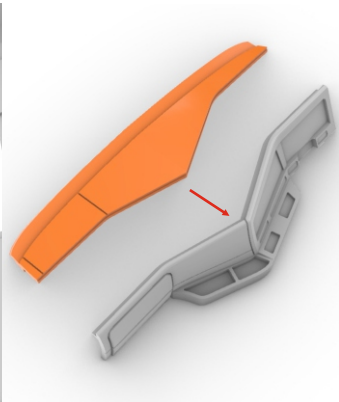

13.  PE-parts

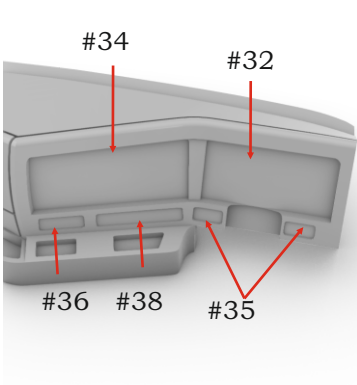

14.  PE-parts

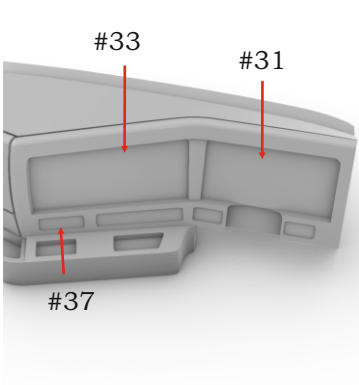

15. 

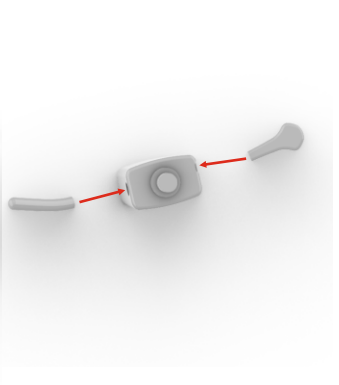

16. 

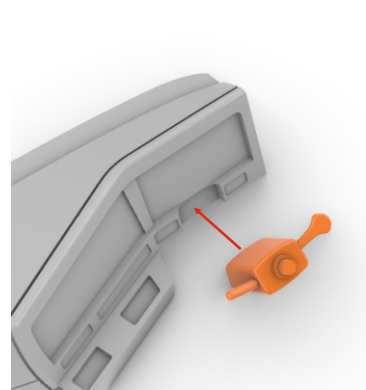

17. 

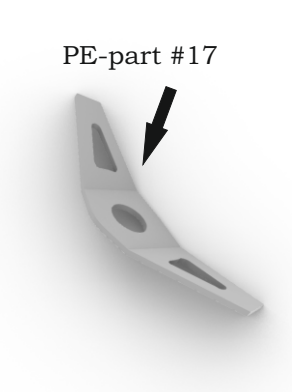

18. 

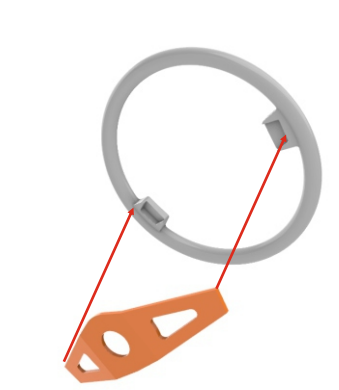

19. 



20. 

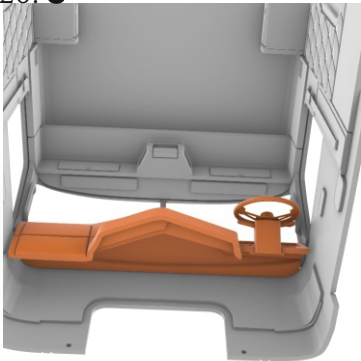

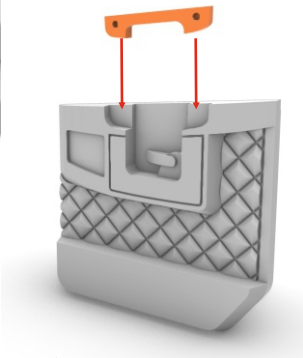

21.  x2

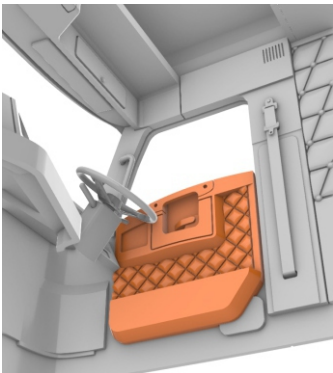

22.  x2



23.  
x2
PE-part #27

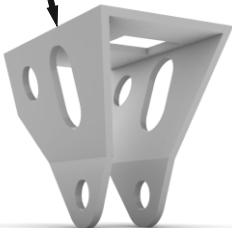

24.  x2



25.  x2

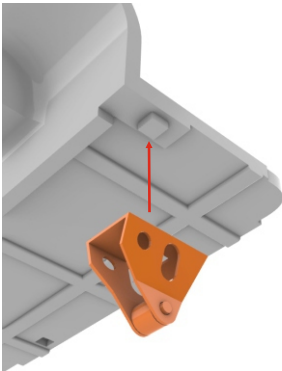

26.  x2

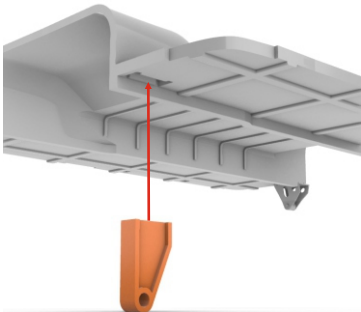

27. 

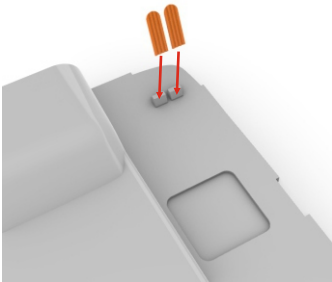

28. 

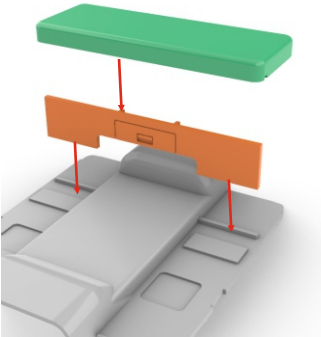

29.  x2

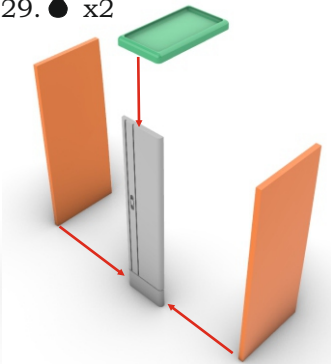

30.  x2

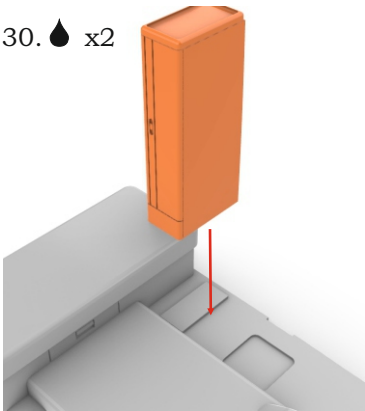

31.  x2



32.  x2



33. 

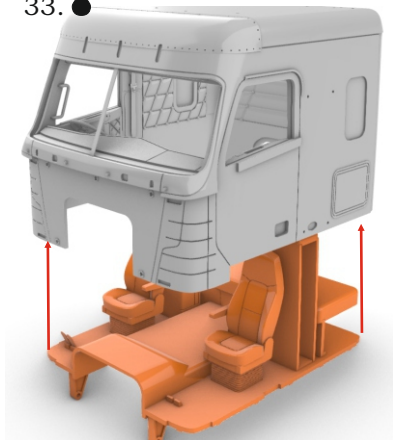

34.  x2

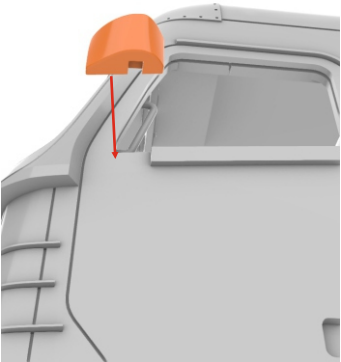

35.  x2

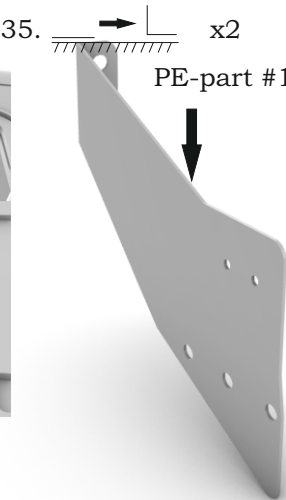

PE-part #14

36.  x2

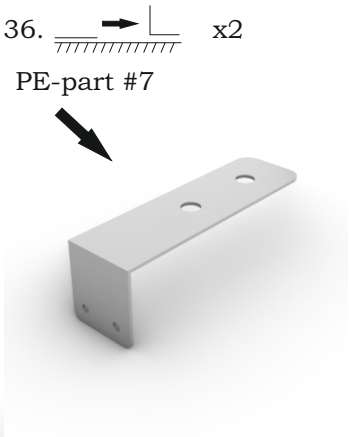

PE-part #7

37.  x2

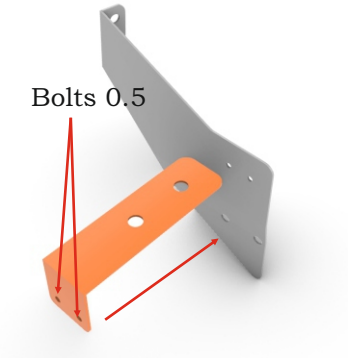

38.  x2

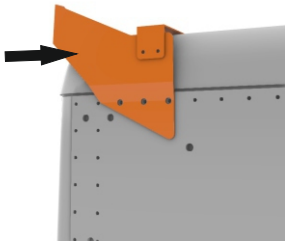
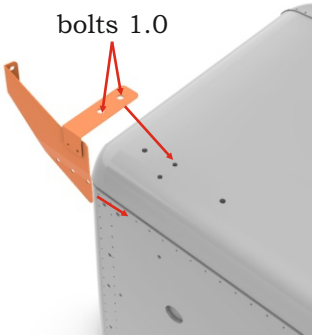

39.  x2

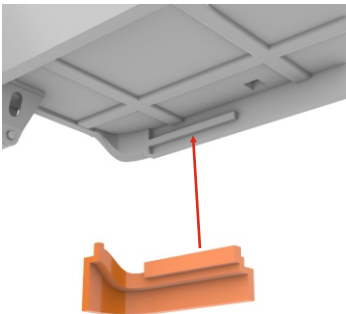

40.  x2
PE-parts

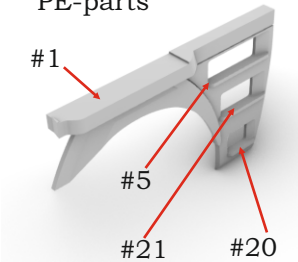

41.  x2



42.  x2

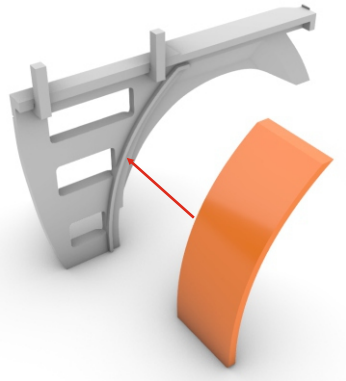

43.  x2

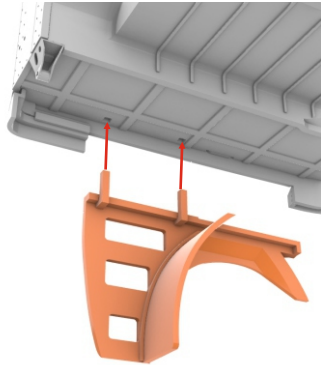

44.  x2

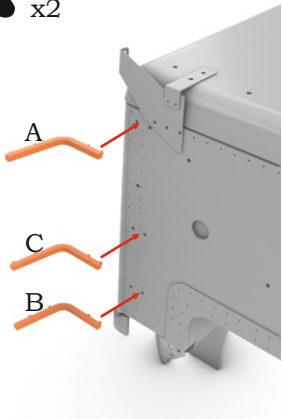

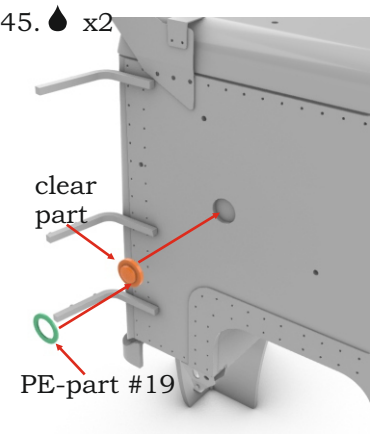

! On next stage A&N photo-etched chassis is used.

Appertures' number can be found on a paper sheet in our chassis kit.

In case if you use Italeri donor, please refer previous section for dimensions.

46.

Jump on step #1 of instruction for A&N Aussie Argosy chassis

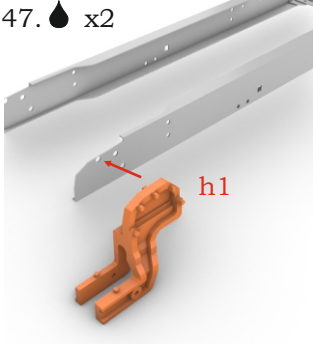

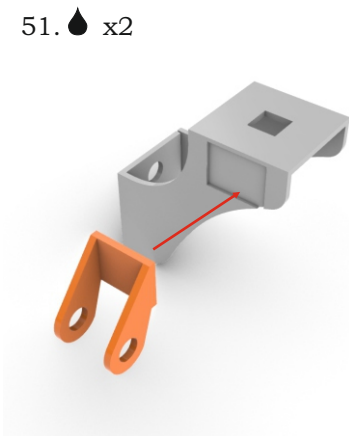
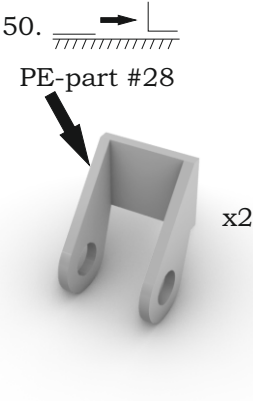
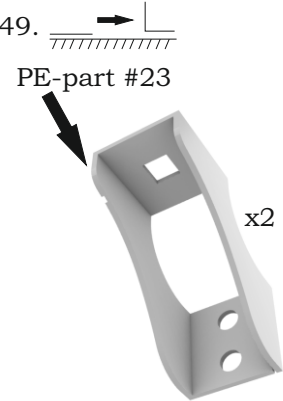

48.

Jump on step #27 of instruction for A&N Aussie Argosy chassis



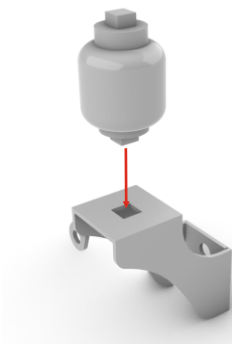

52.  x2

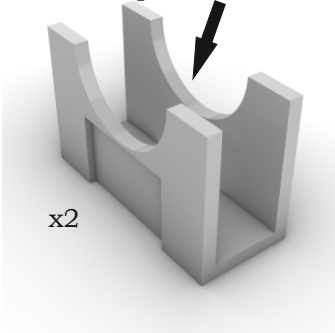

53.  
PE-part #24



54.  
PE-part #25

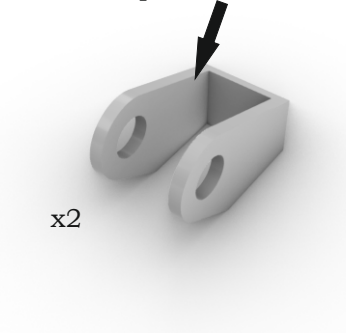

55.  x2

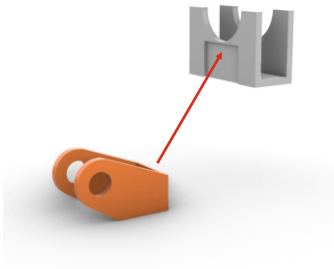

56.  x2

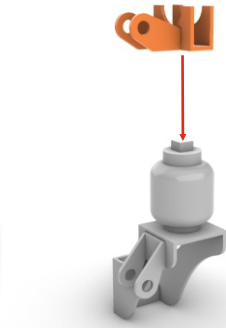

57.  x2

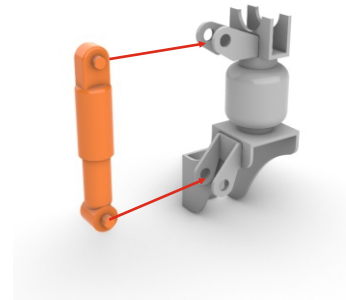

58.  x2

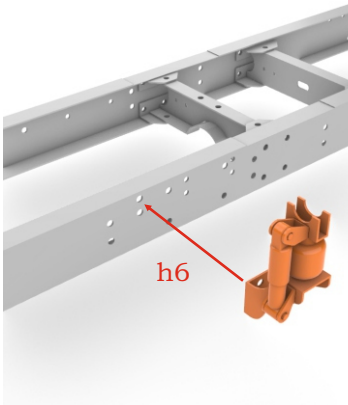

59.  x2

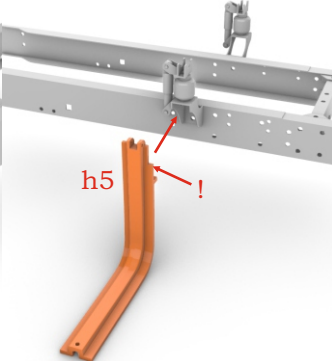

60.  x4

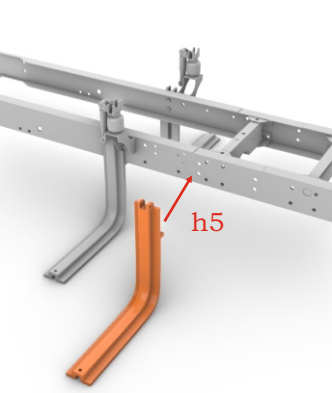

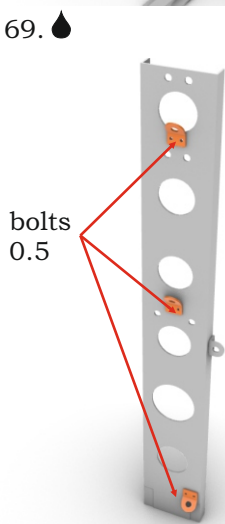
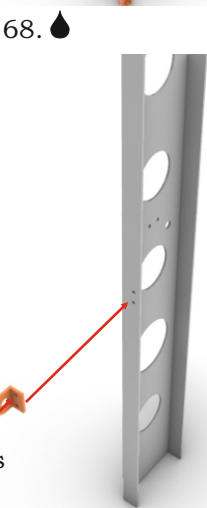
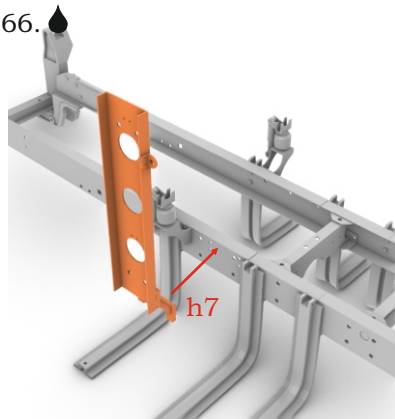
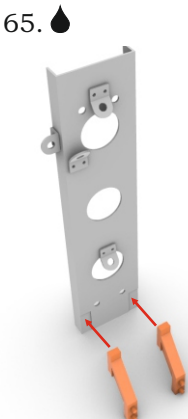
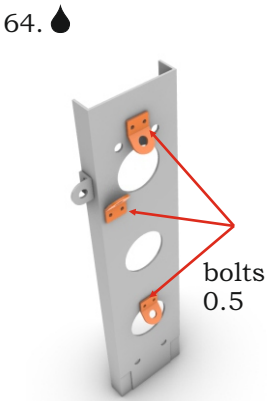
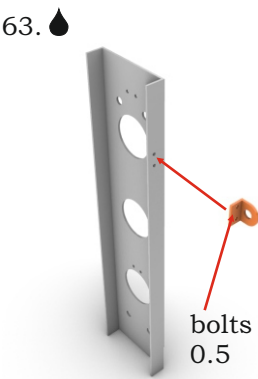
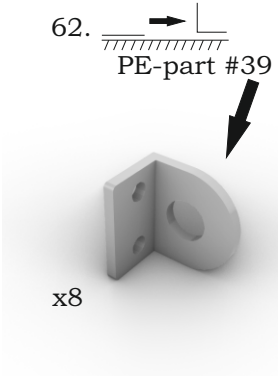
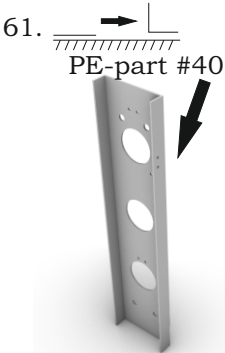

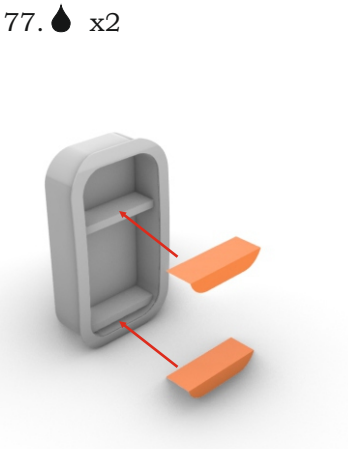
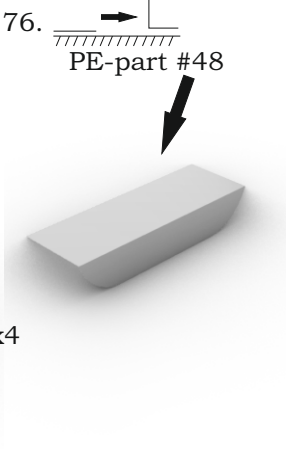
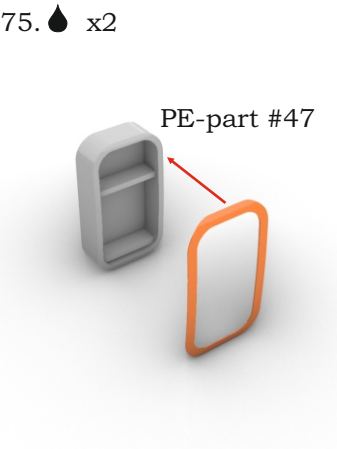
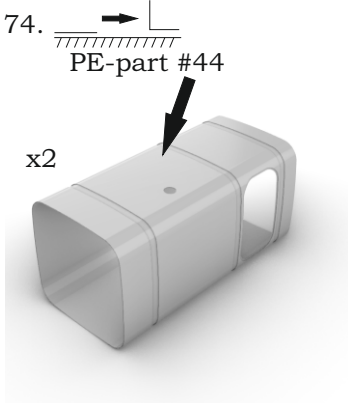
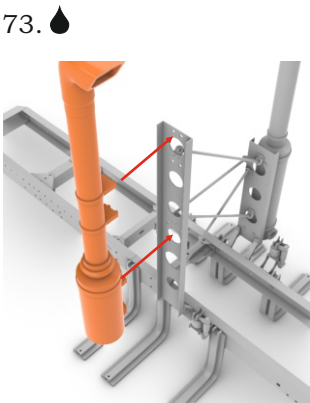
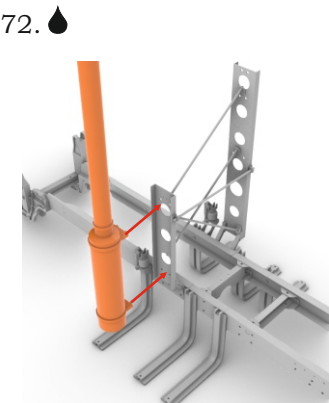
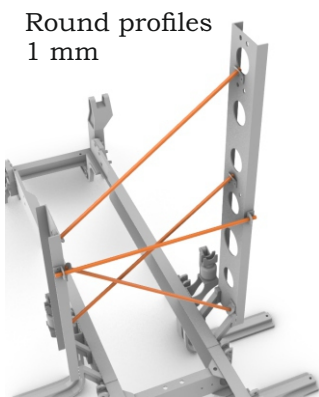
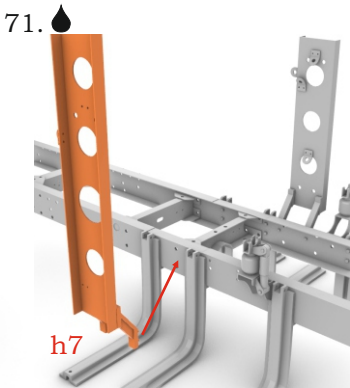
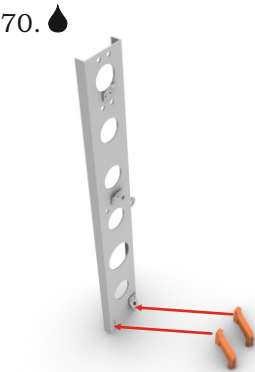

78.  x2

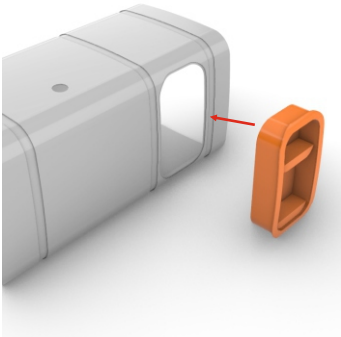

79.  x2

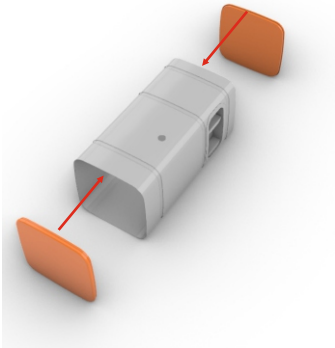

80.  x2

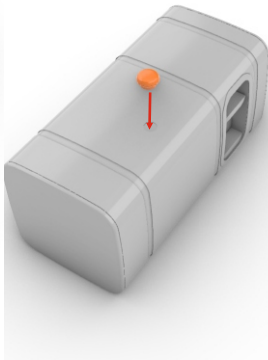

81.  PE-part #49

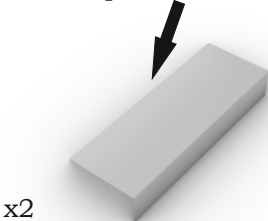

82.  x2

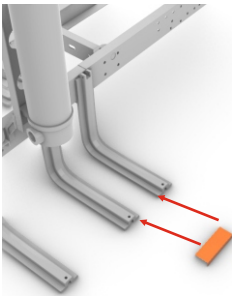

83.
Jump on step #48
of instruction for
A&N Aussie Argosy
chassis's

84.  PE-part #45

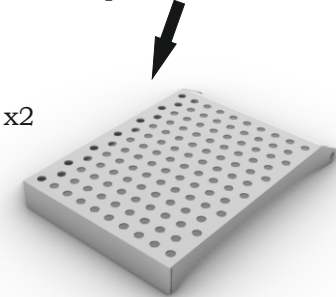

85.  x2 bolt 1mm

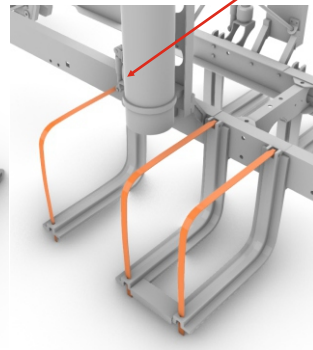

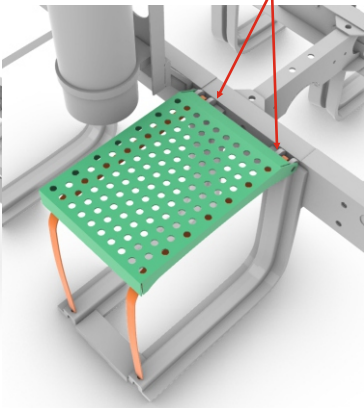

86.  x2 bolt 1mm



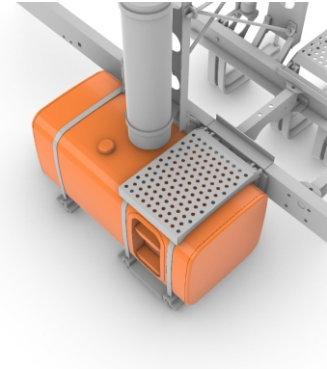

PE-part #46

87.  x2

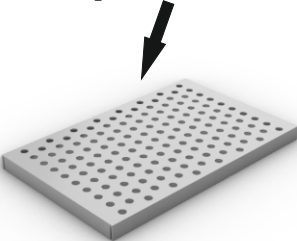

88.  
PE-part #4



89.  
PE-part #9

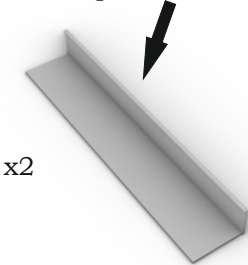

90.  x2

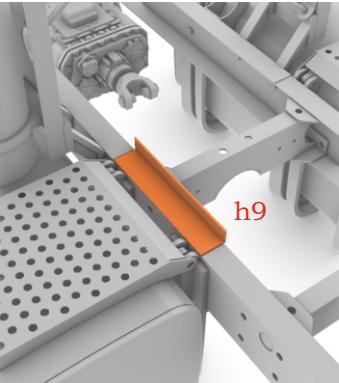

91. 

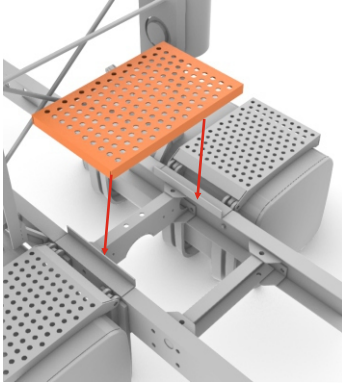

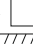
92.  
PE-part #26



93.  x2

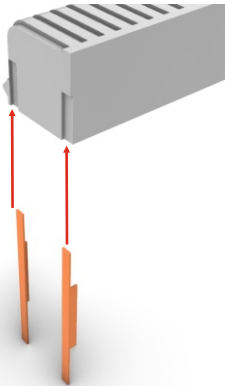

94. 

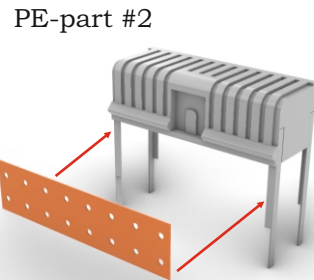

95. 

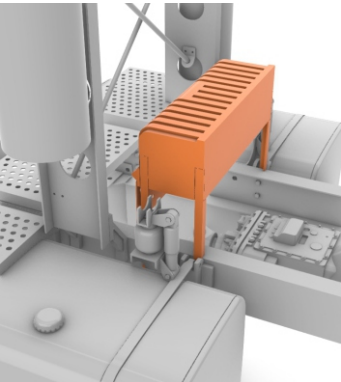

96. 

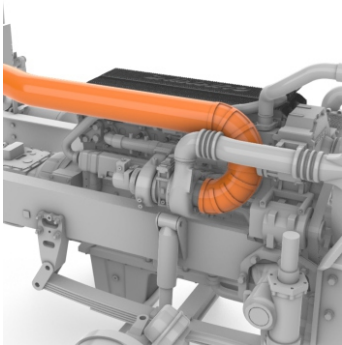

97. 

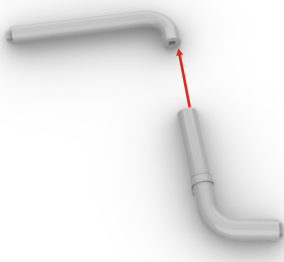
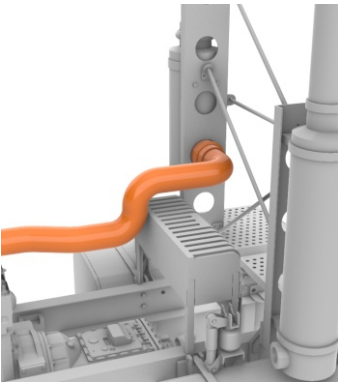

98. 

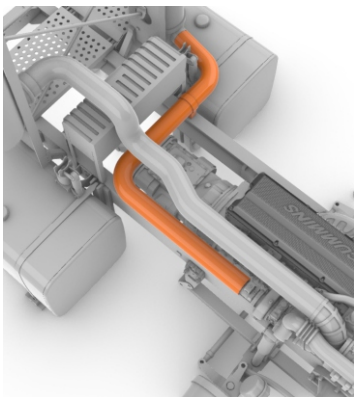

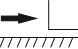
99. 
PE-part #3

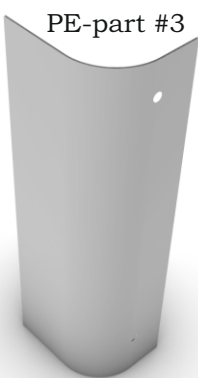

100. 

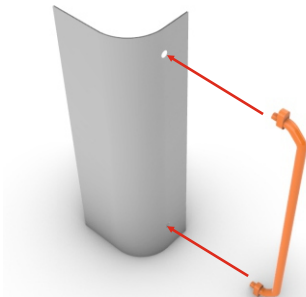

101. 

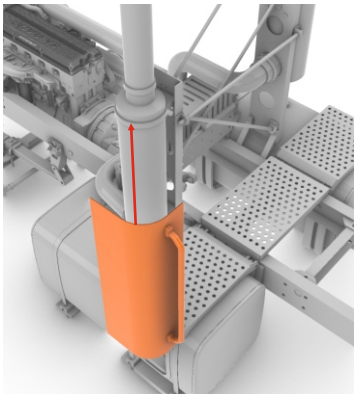

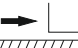
102. 
PE-part #43

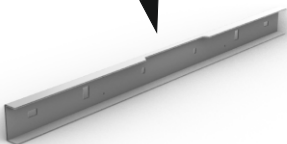

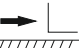
103. 
PE-part #41



104. x2

bolts 0.5 mm

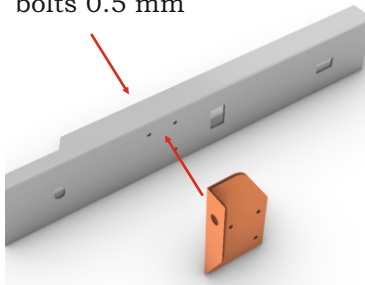

105. x2

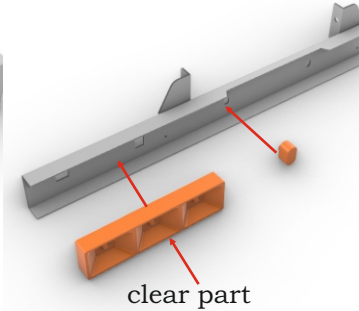

106.

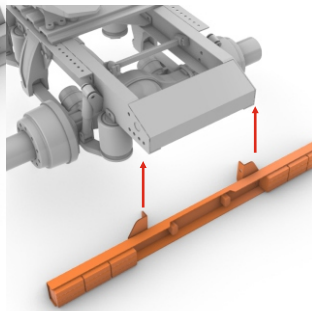

107.

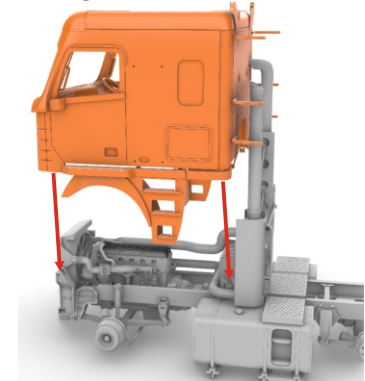

108. x2 round profile 2mm

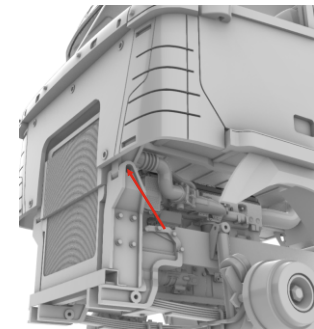

109. x2

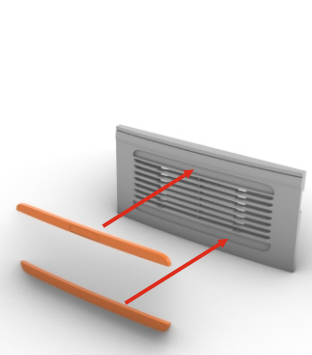

110.

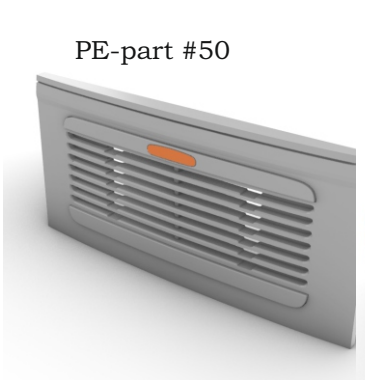

PE-part #50

111.

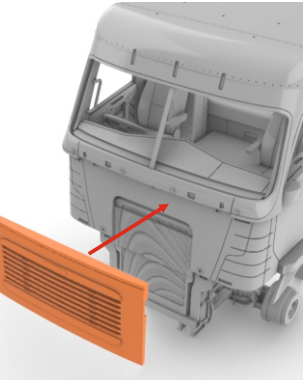

112. x2

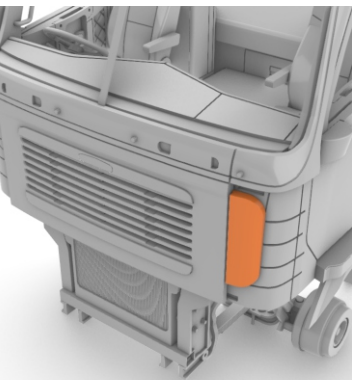

Aussie Argosy (1st gen.). Resin kit, 1/24

113. x2

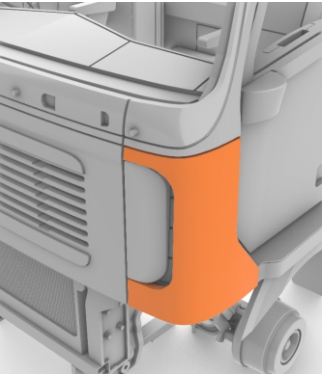

114. x2

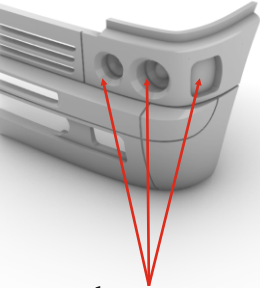

clear part

115.

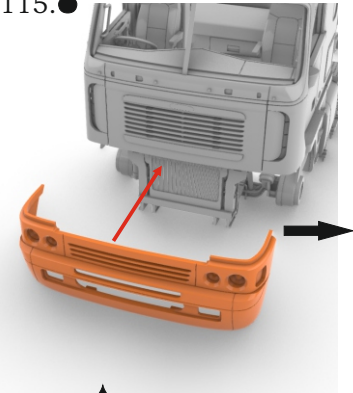

116. x2

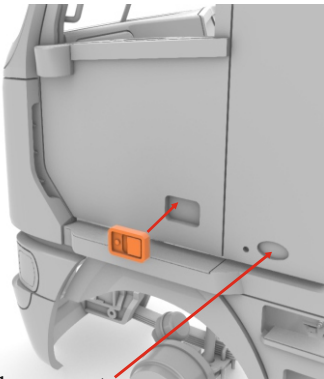

clear part

117. x2

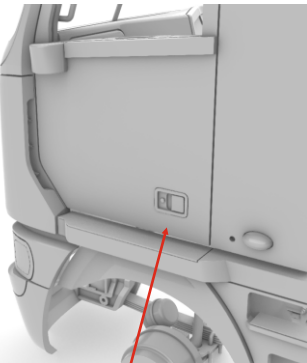

PE-part #30

118. x2

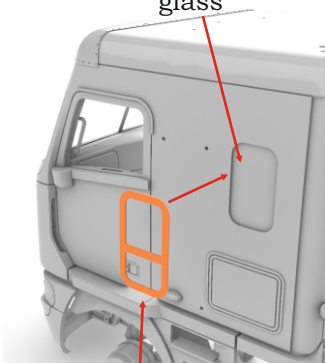

PE-part #22

119. x2

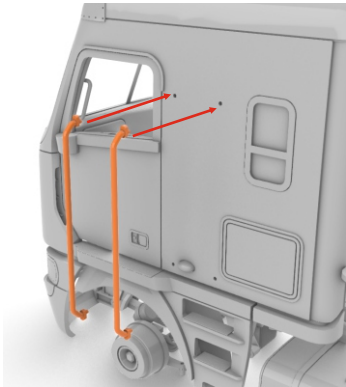

120. x2

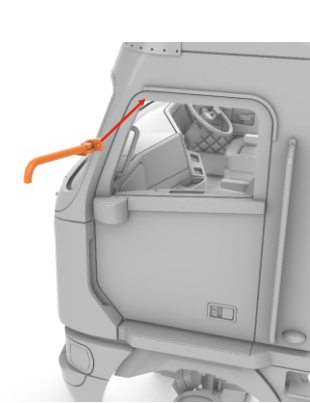

121. x2



122. x2

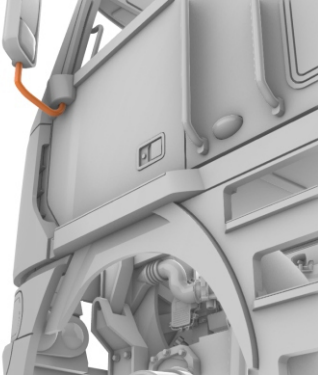

123.

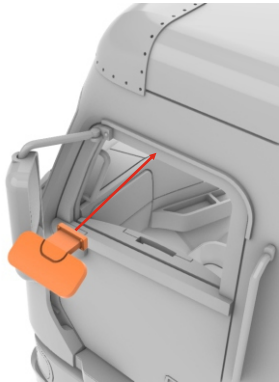

124. x2

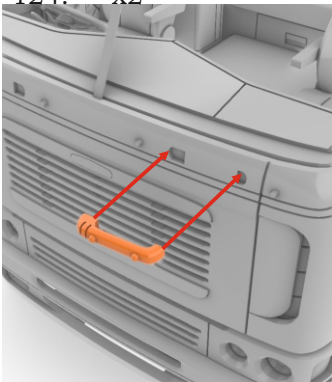

125. x2

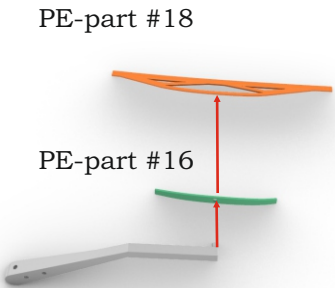

126. x2



127. x2



128.

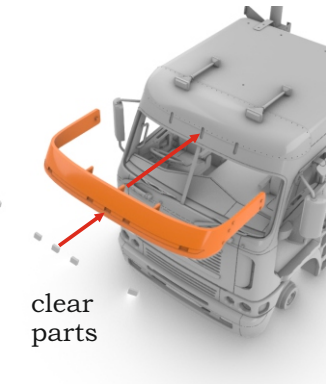

129.

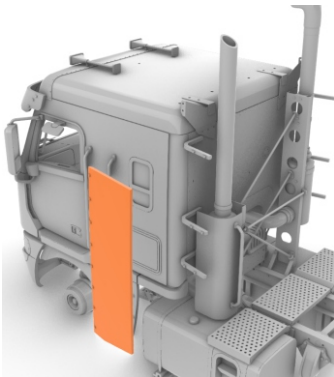

Aussie Argosy (1st gen.). Resin kit, 1/24

130.💧

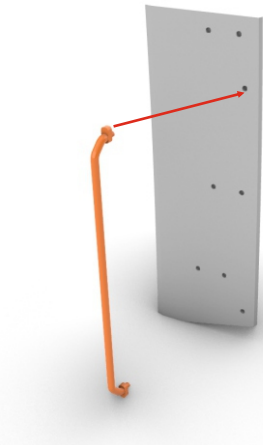

131.💧

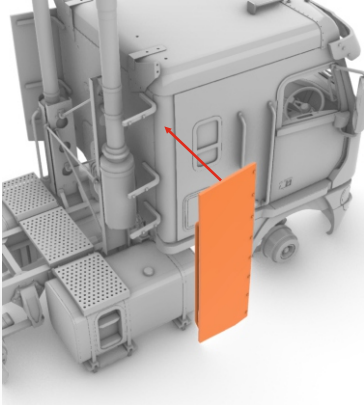

132.💧 x2

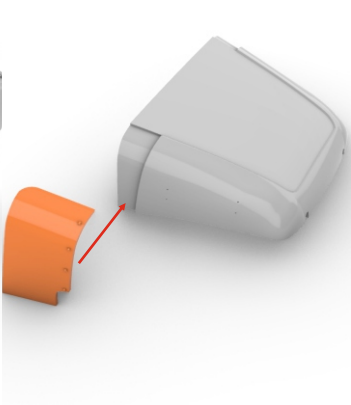

133.💧

