

# A&N Model Trucks

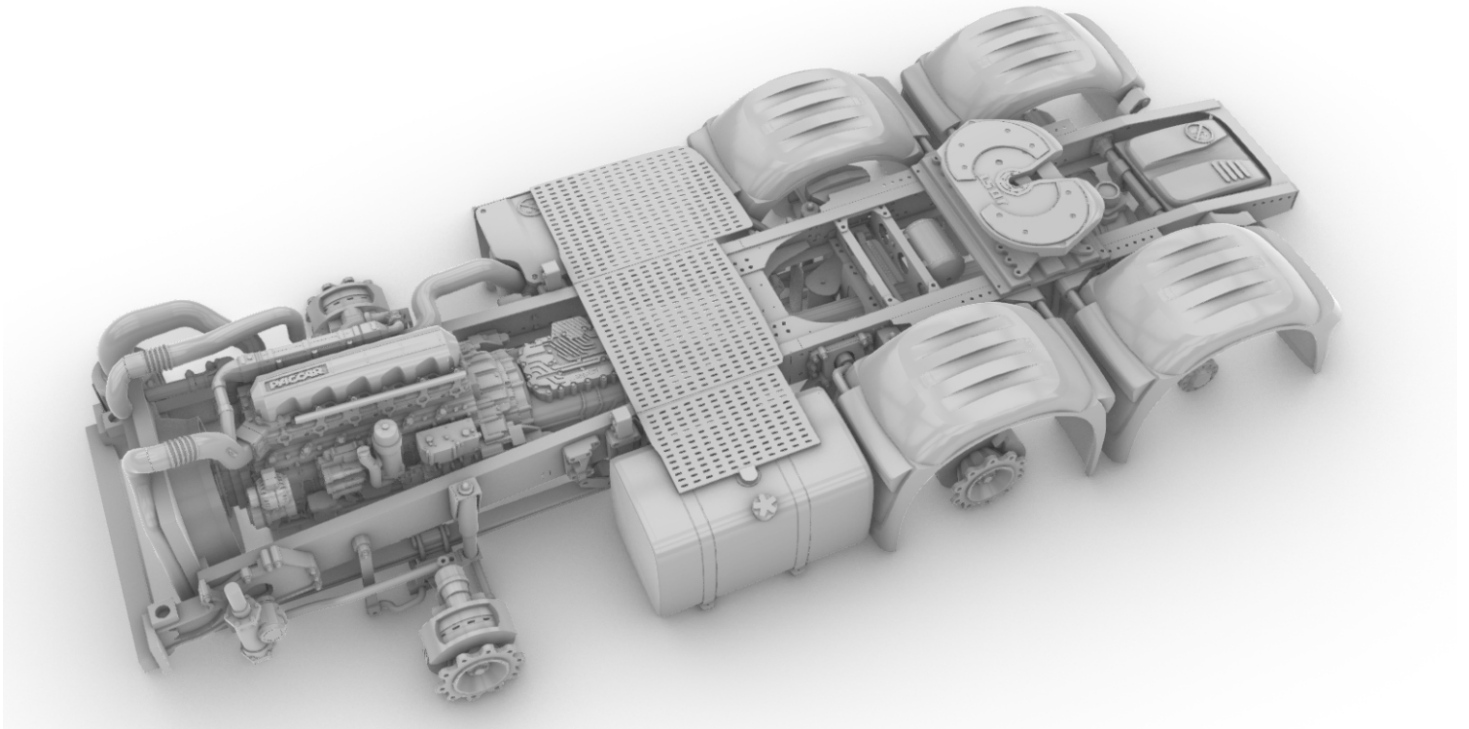

## Dutch truck XG+ pusher chassis (4.15)

Multimedia kit, 1/24

## Warning!

Read carefully this instruction and please follow it during assembling, otherwise you could face problems with assembling the model.

Photo-etched parts have sharp edges, please be careful.

This model kit contains very small parts and is not suitable for children. THIS IS NOT A TOY!

We suggest to solder photo-etched frames. Check how-to videos on our [YouTube channel](#).

---

## Symbols:

 - glue parts;

 - do not glue parts;

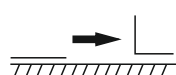
 - bend parts;

 - attention;

 - moving parts;

 - your choice;

 - cut;

 - drill;

Dutch truck XG+ pusher chassis (4.15). Scale 1/24

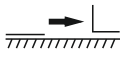
1.   
PE-part #1

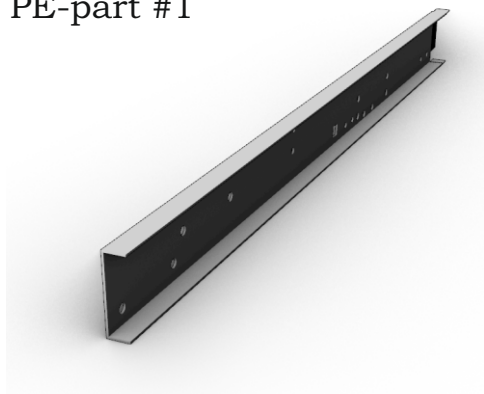

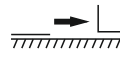
2.   
PE-part #2

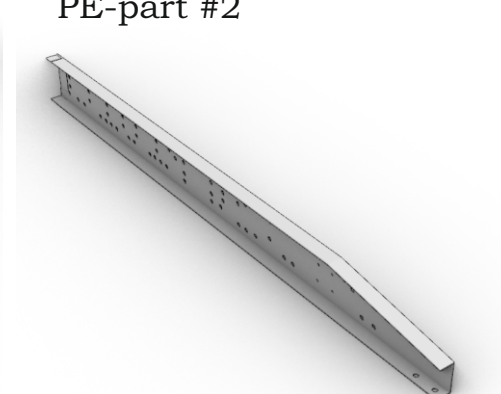

3. 

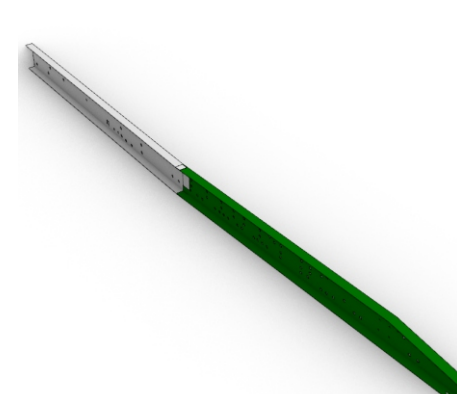

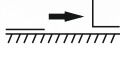
4.  x2  
PE-part #7

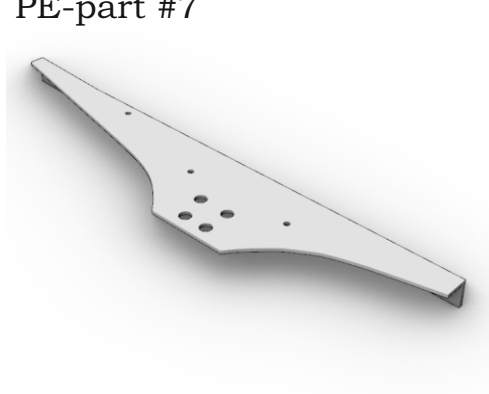

5. 

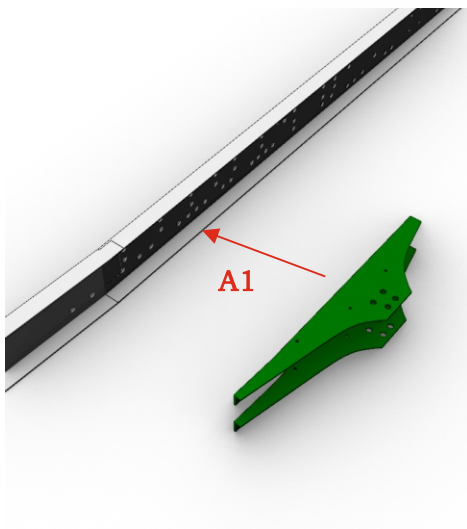

6.  x2  
PE-part #30

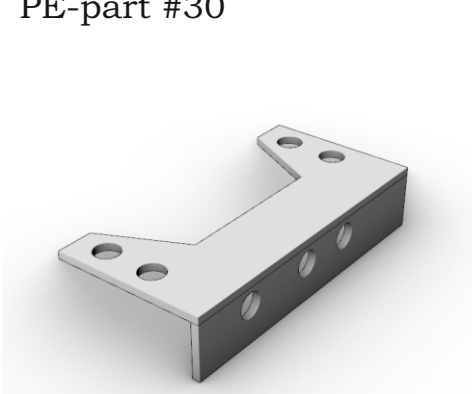

7. 

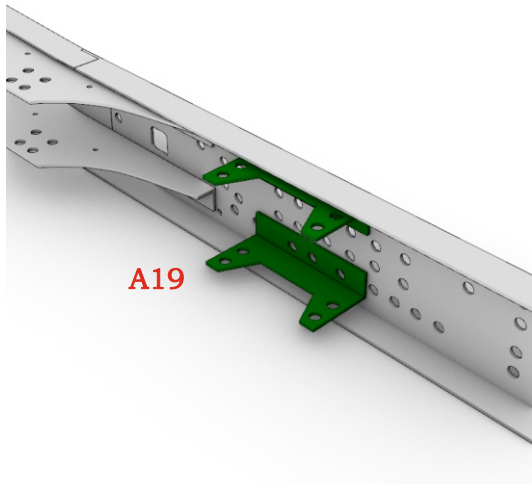

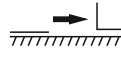
8.   
PE-part #10

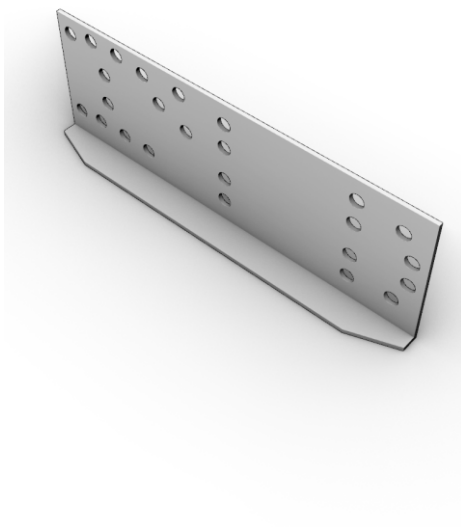

9. 

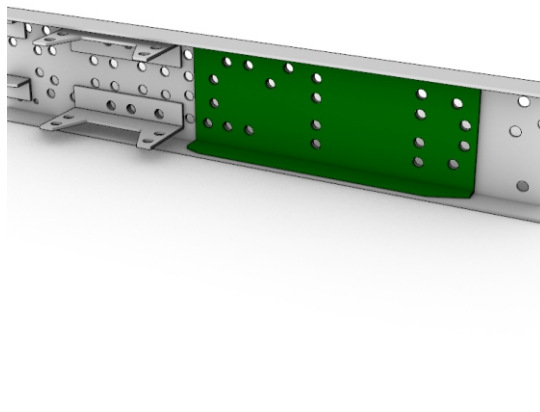

Dutch truck XG+ pusher chassis (4.15). Scale 1/24

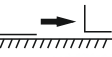
10.   
PE-part #14

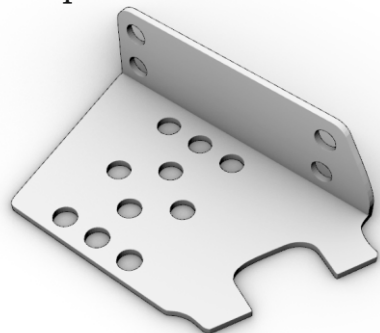

11. 

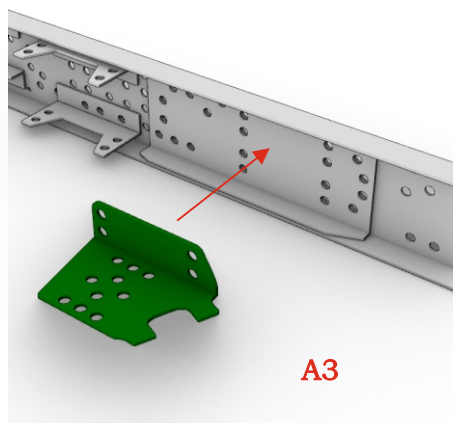

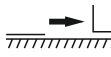
12.   
PE-part #5

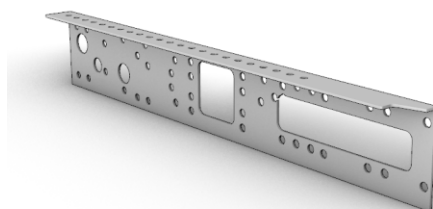

13. 

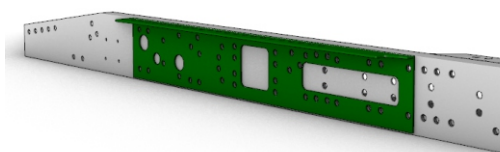

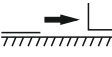
14.   
PE-part #16

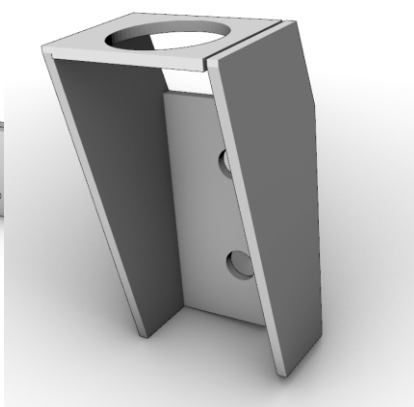

15. 

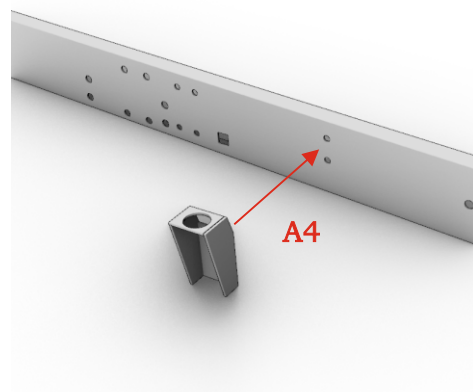

16. 

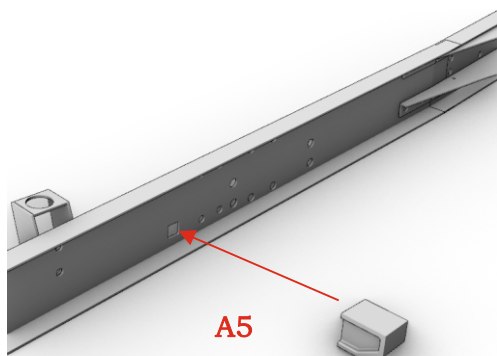

17.  
Repeat steps 1-16 for  
right side.

18.  x2  
PE-part #13

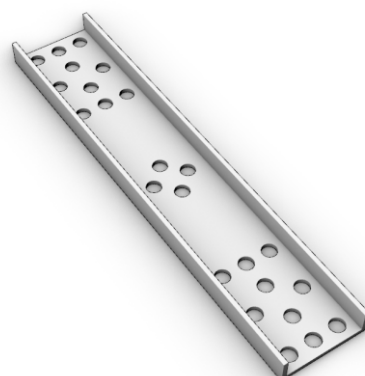



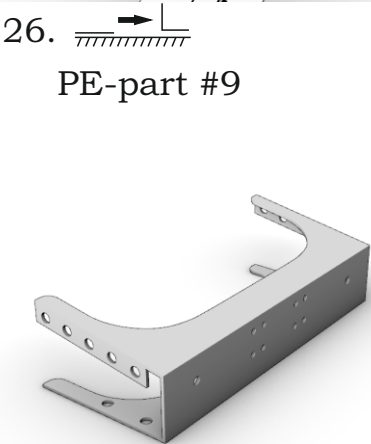
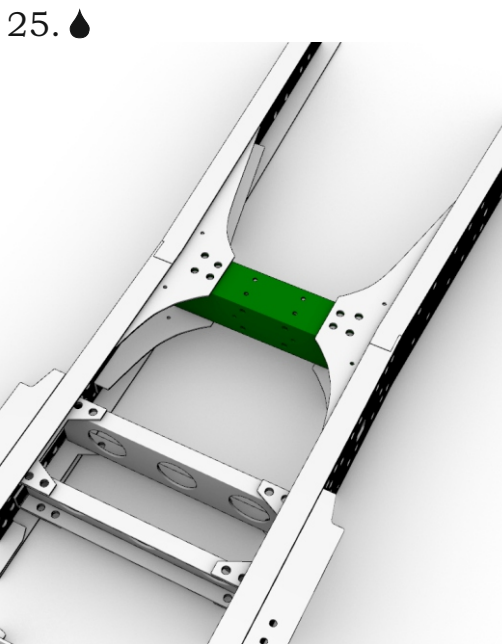
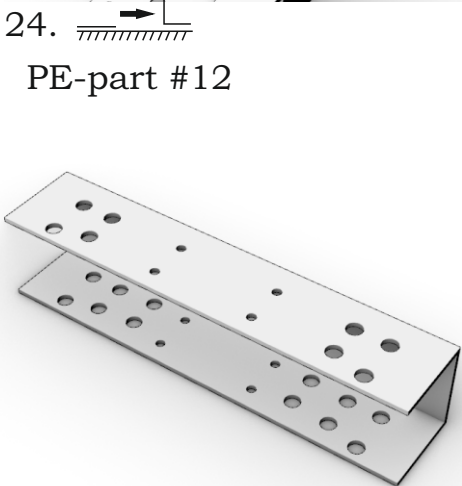
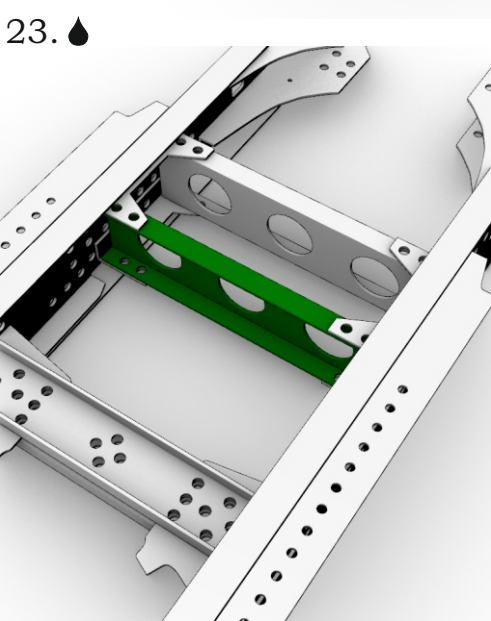
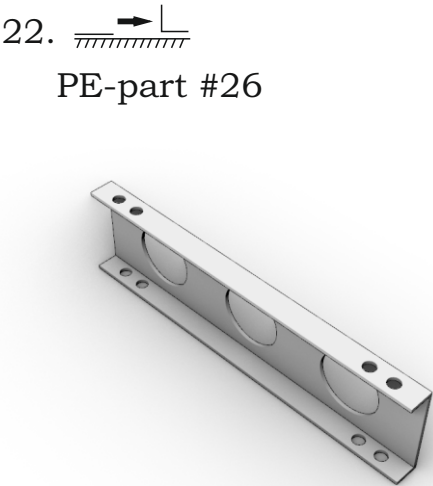
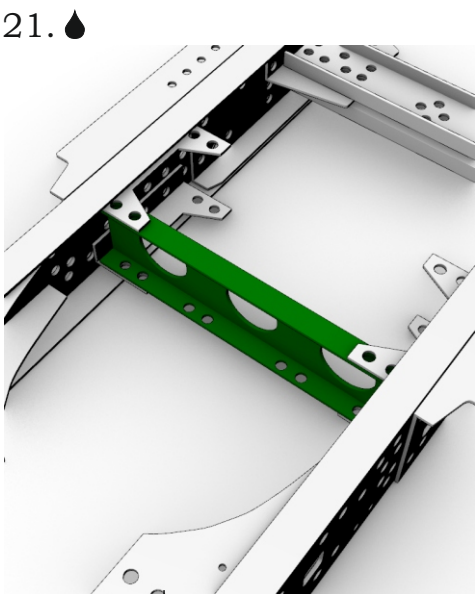
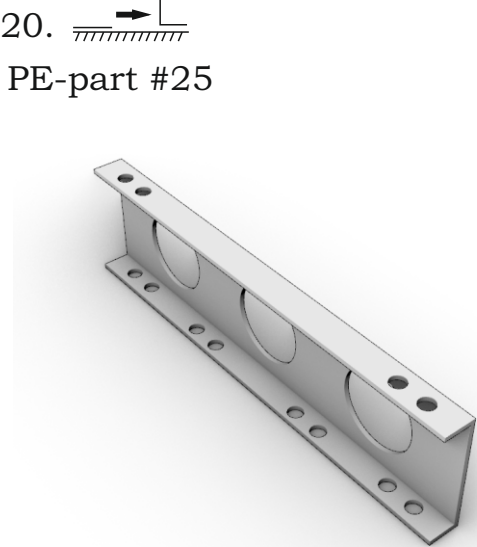
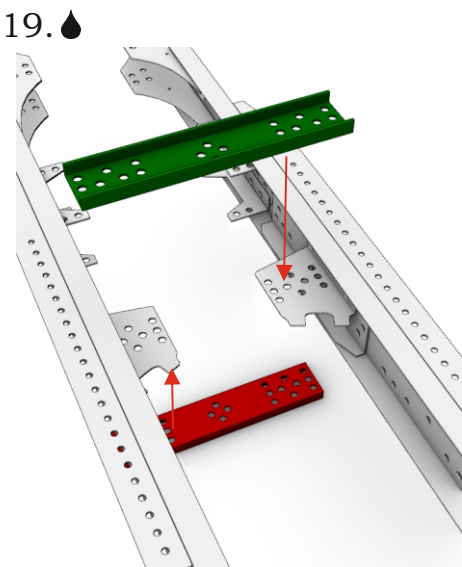

Dutch truck XG+ pusher chassis (4.15). Scale 1/24

28. x2

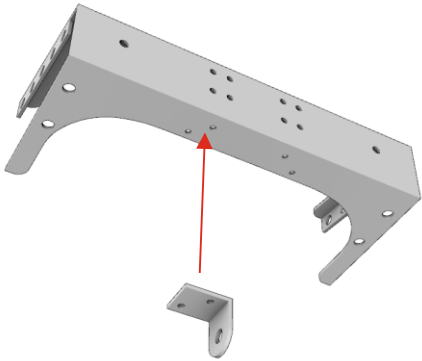

29.

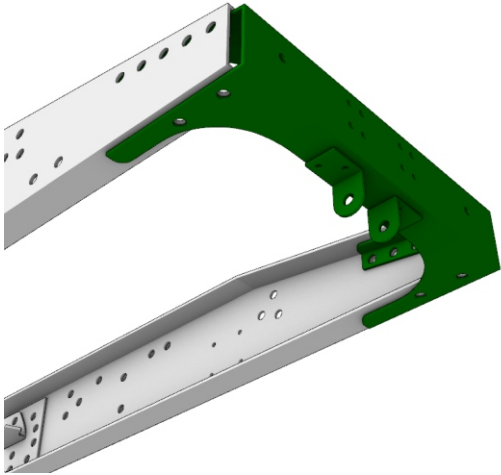

30. x2

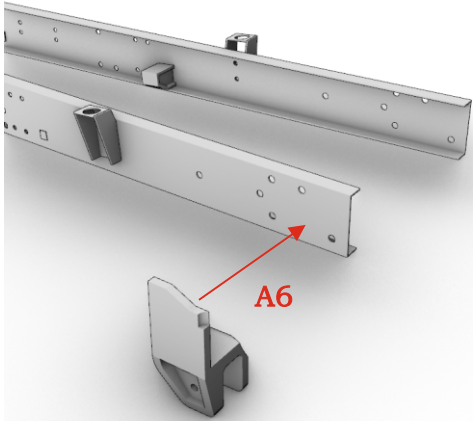

31. x2

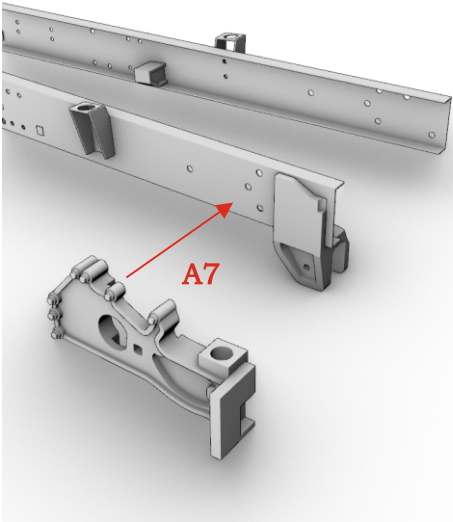

32.

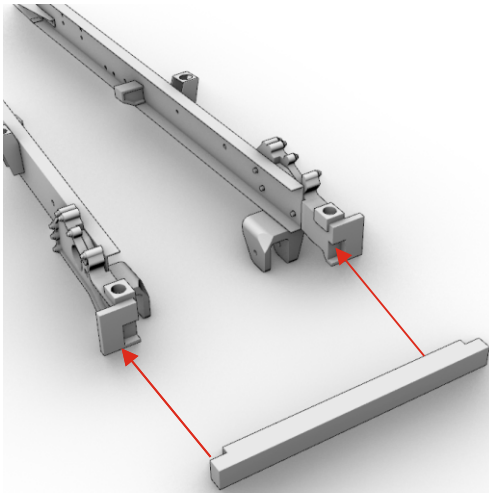

33. x8

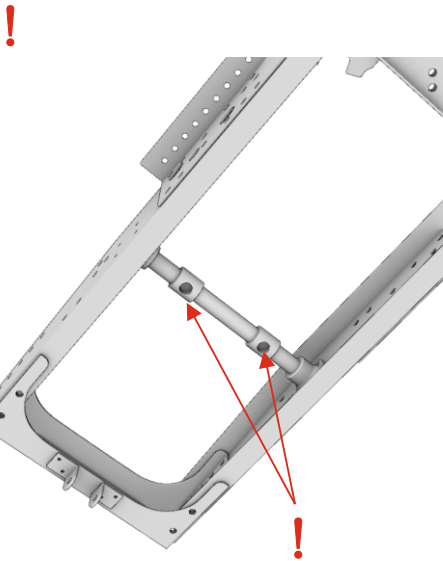
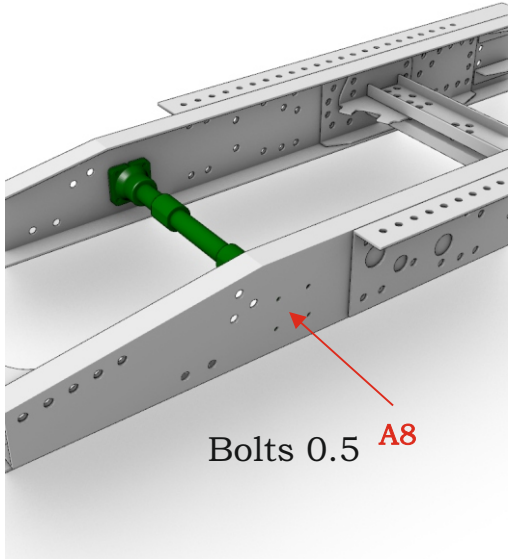

34. x4  
PE-part #18

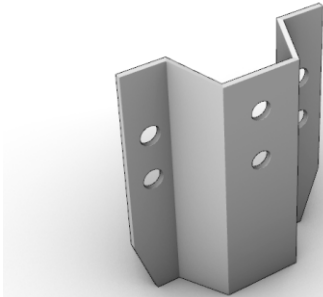

35.

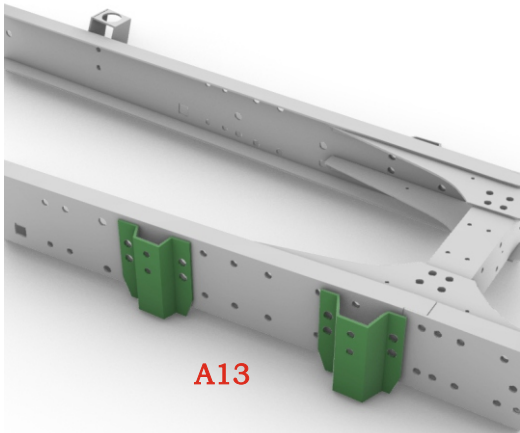

Dutch truck XG+ pusher chassis (4.15). Scale 1/24

36. 

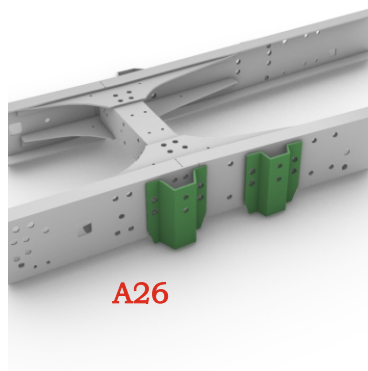

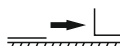
37. 

PE-part #21

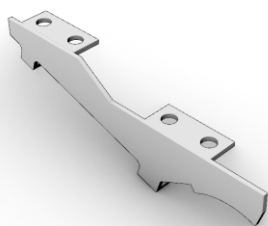

38.  x4

Bolts 1 mm

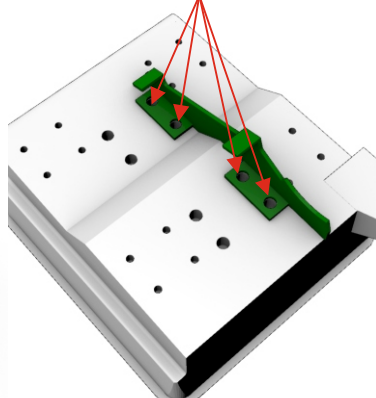

39.

Repeat steps 37-38 for other side

40. 

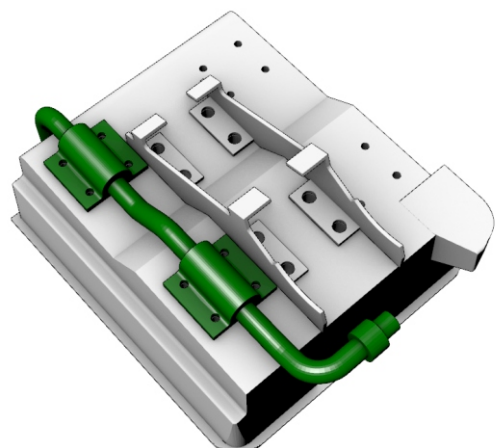

41. 

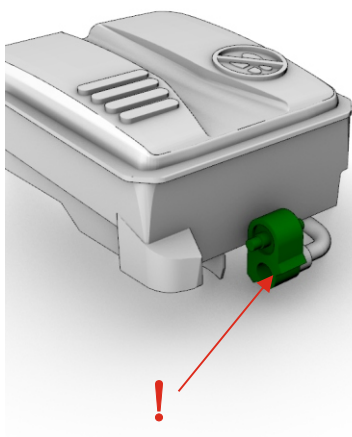

42. 

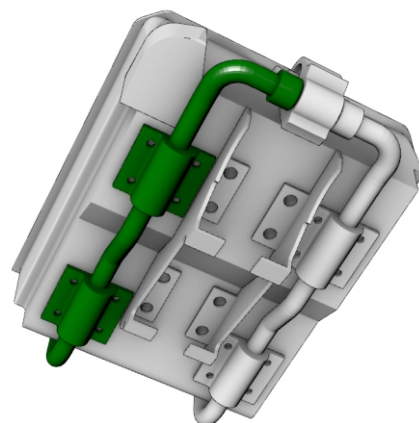

43. 

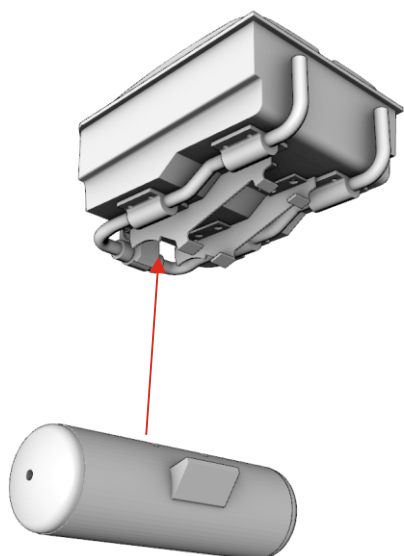

44. 

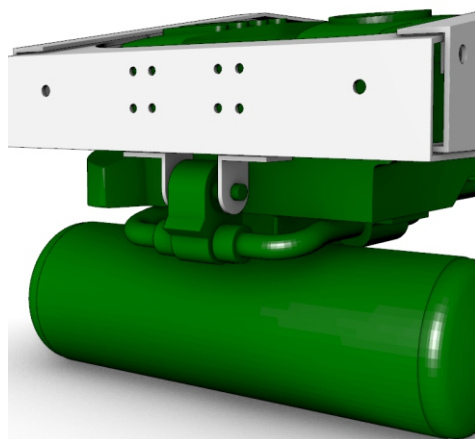
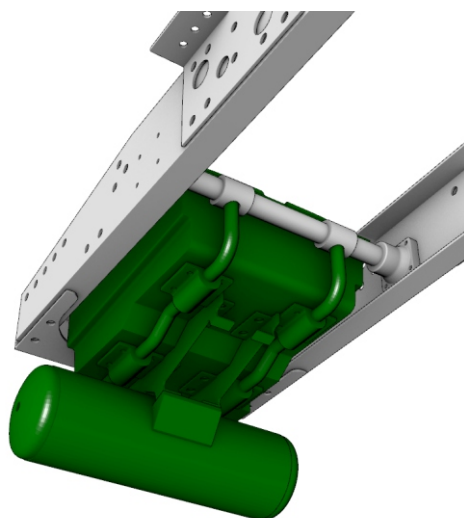



Dutch truck XG+ pusher chassis (4.15). Scale 1/24

45. 🟩

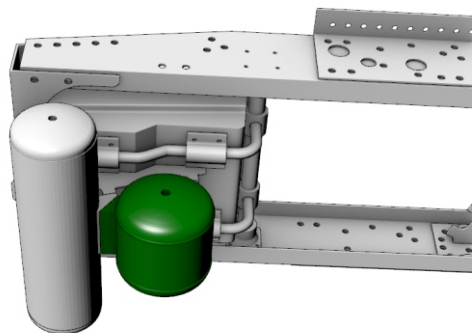

46. 🟩 x2

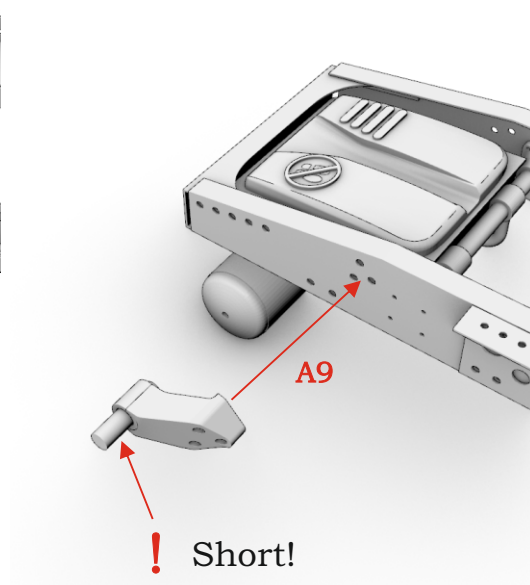

47. 🟩 x2

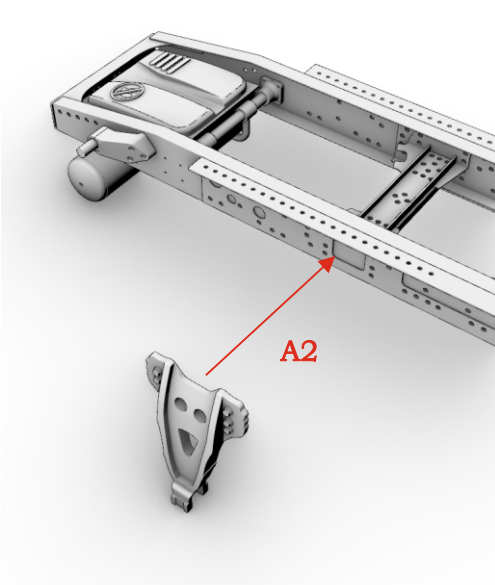

48. 🟩 x2

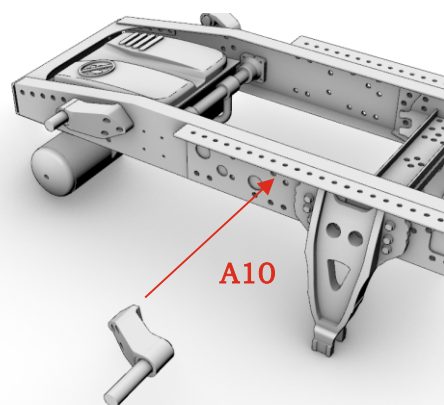

49. 🟩 x2

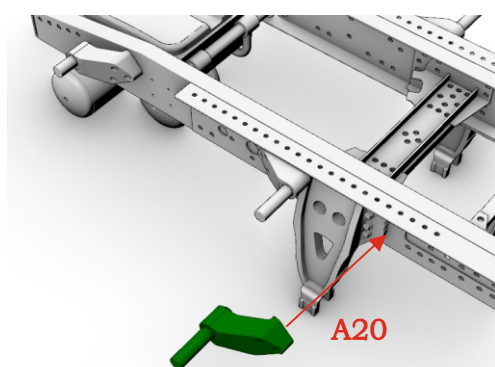

50. 🟩 x2

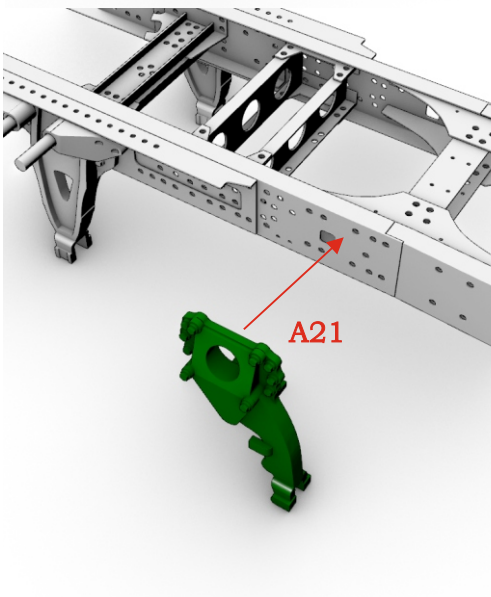

51. 🟩 x2

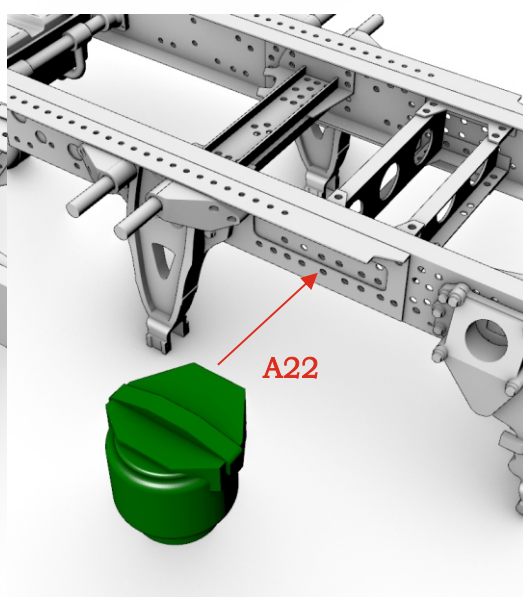

52. 🟩

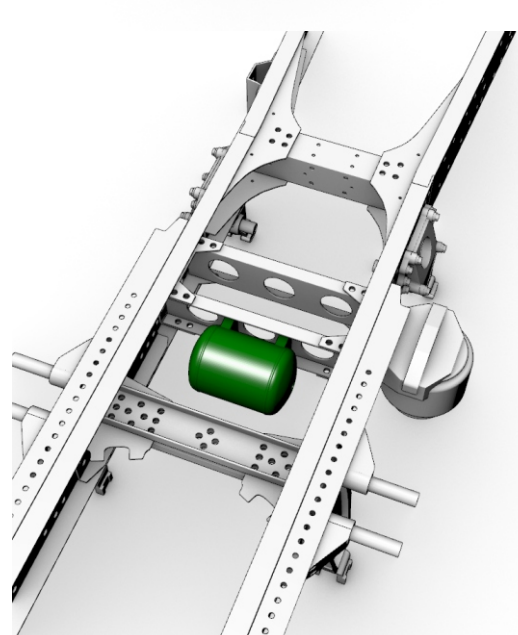

Dutch truck XG+ pusher chassis (4.15). Scale 1/24

53. 🟩 x2

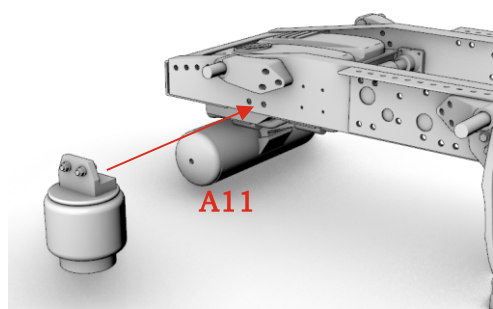

54. 🟩 x2

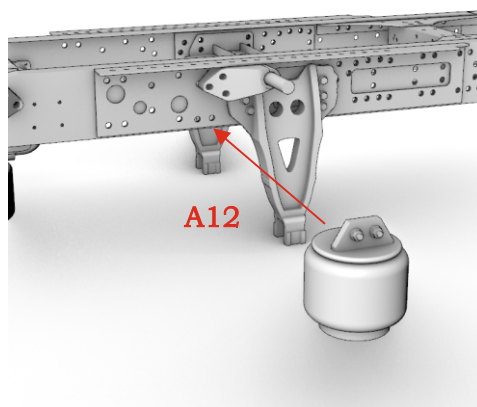

55. 🟩 x2

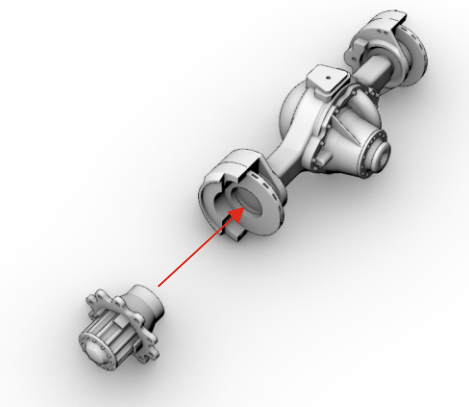

56. 🟩 x2

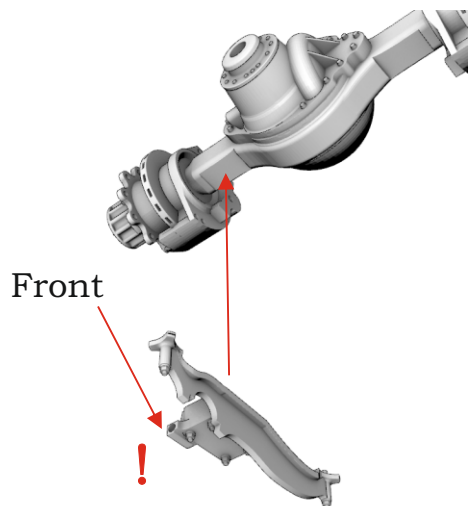

57. 🟩 x4

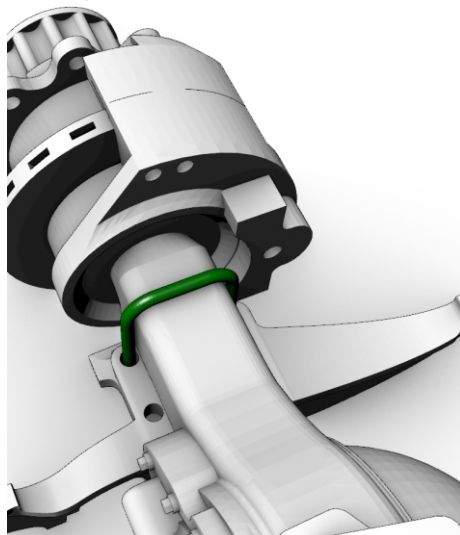

58. 🟩 x2

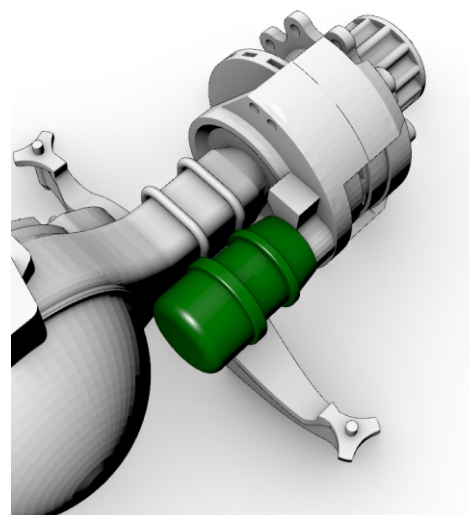

59. 🟩

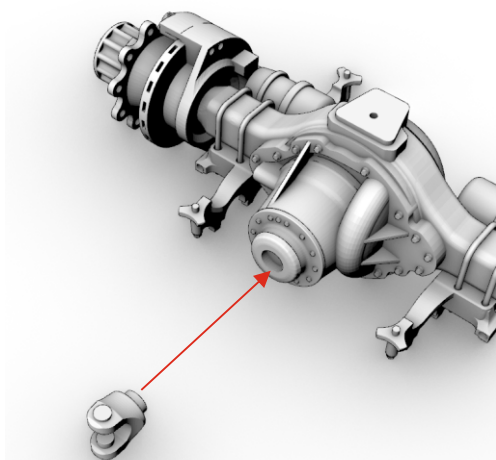

60. 🟩

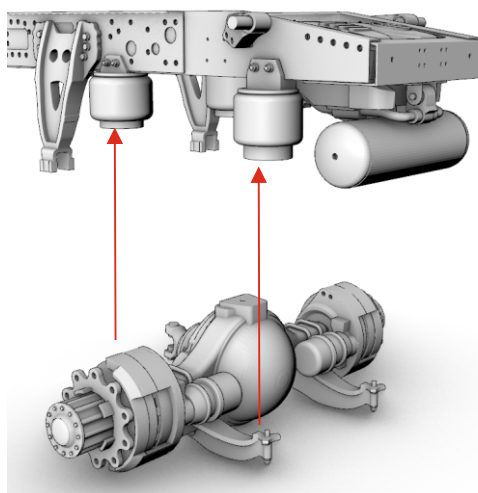

61. 🟩

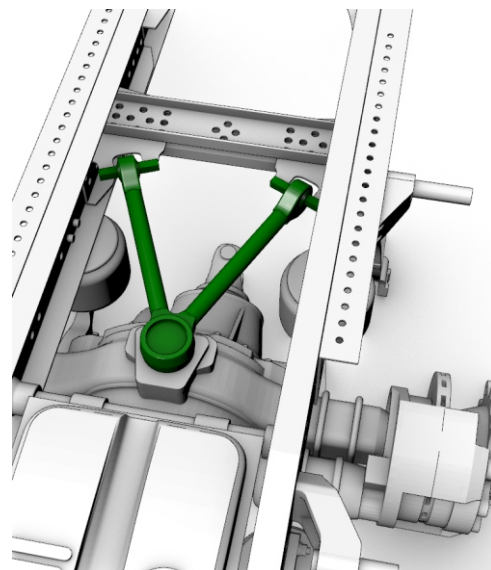



Dutch truck XG+ pusher chassis (4.15). Scale 1/24

62. 🖐️ x2

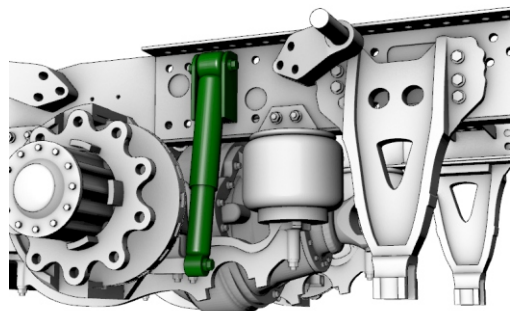

A16

63. 🖐️

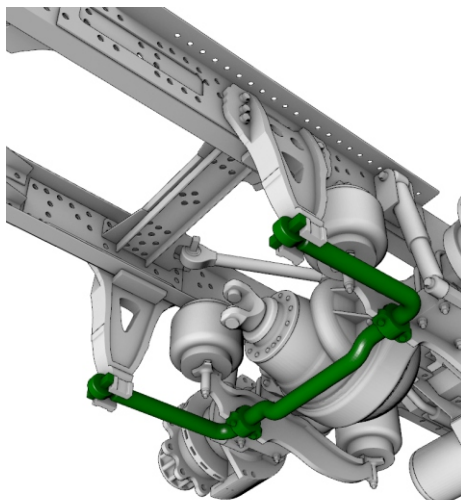

64. 🖐️

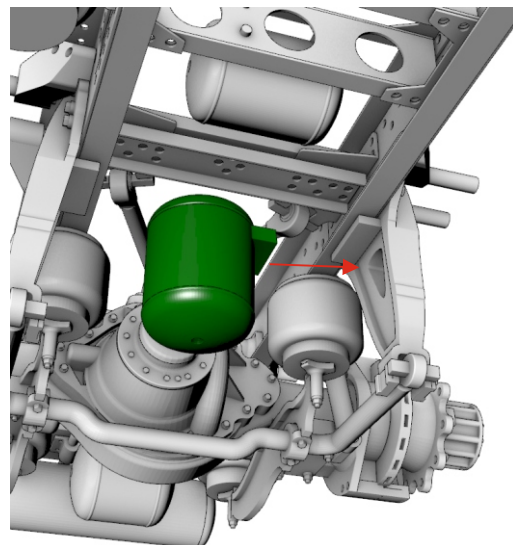

65. 🖐️

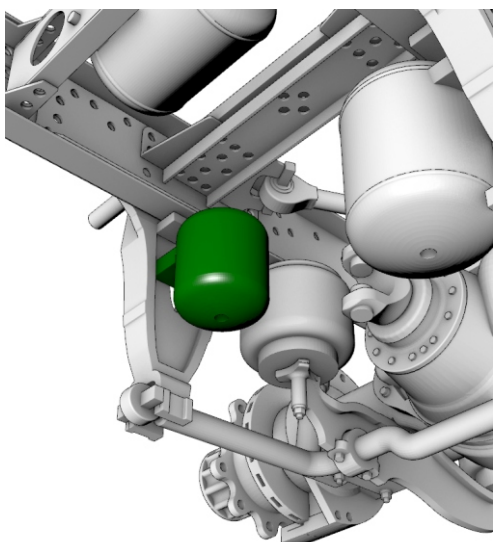

66. 🖐️

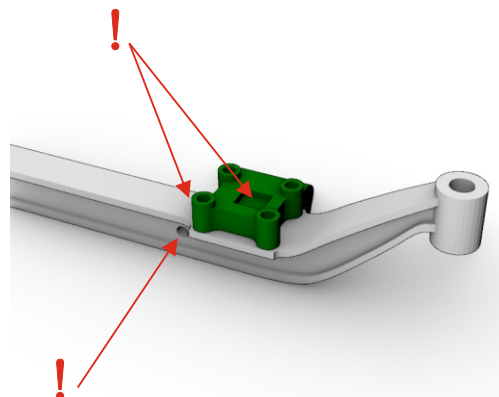
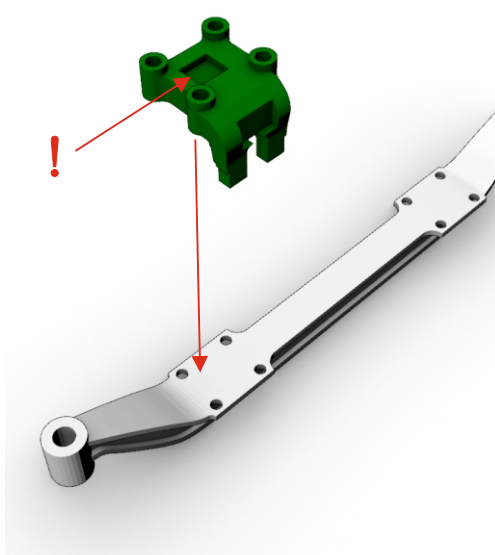

67. 🖐️

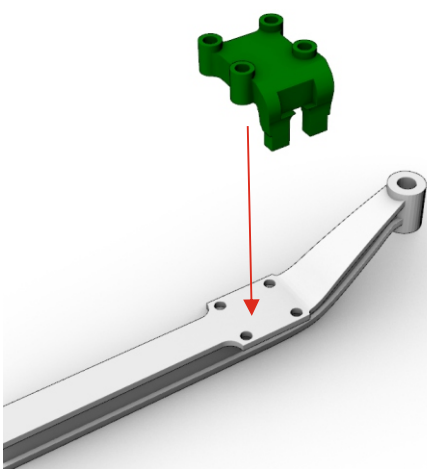

68. 🖐️

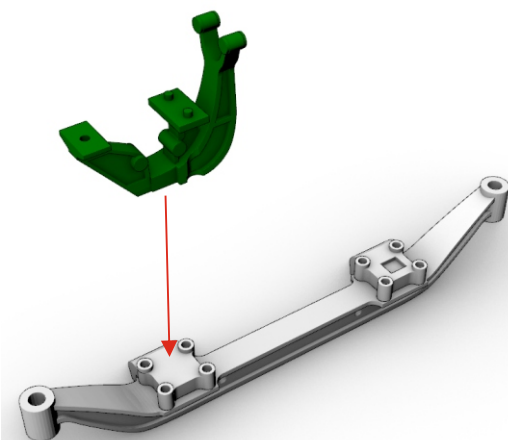

69. 🖐️

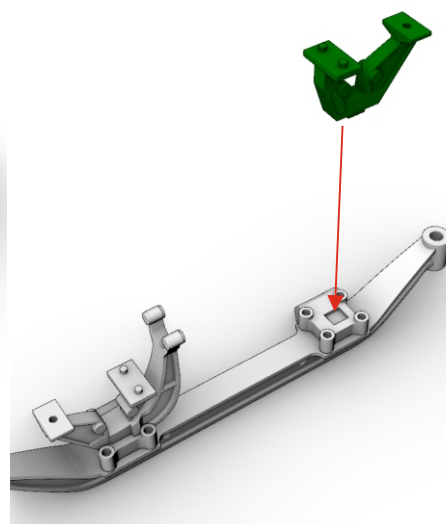

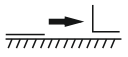

Dutch truck XG+ pusher chassis (4.15). Scale 1/24

70.  x2  
PE-part #27



71.  x2

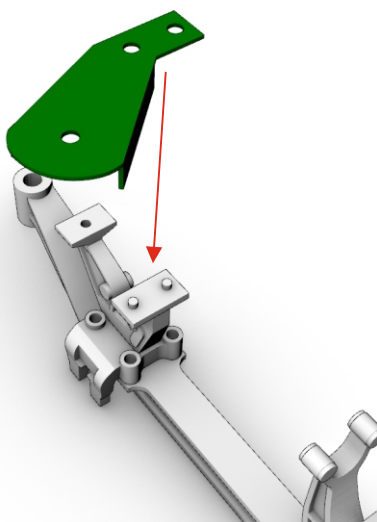

72.  x2

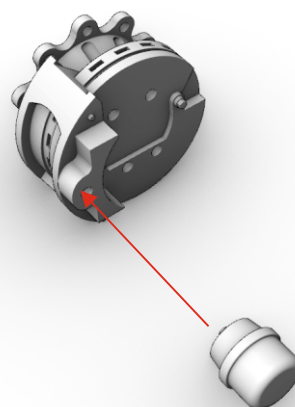

73.  x2

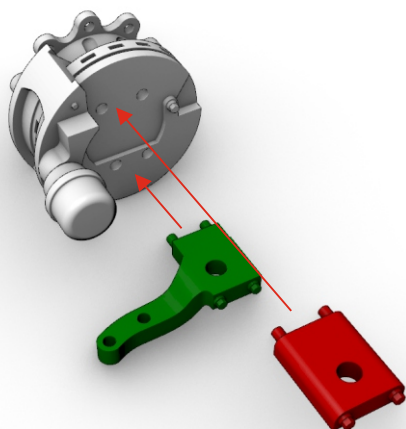

74.  x2

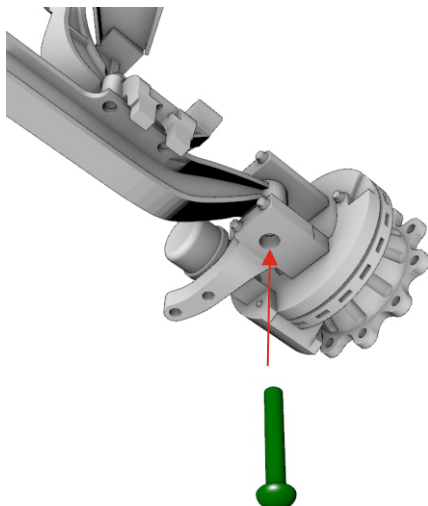

75.  x2

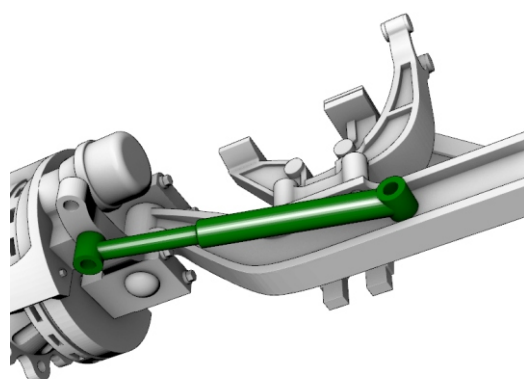

76. 

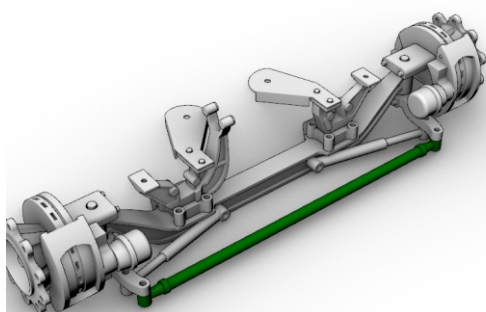

77. 

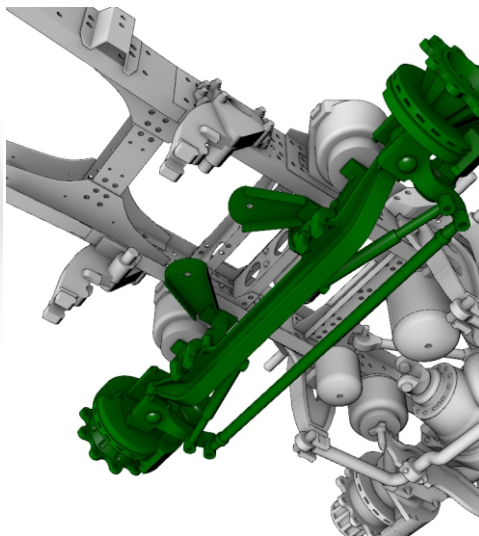

78. 

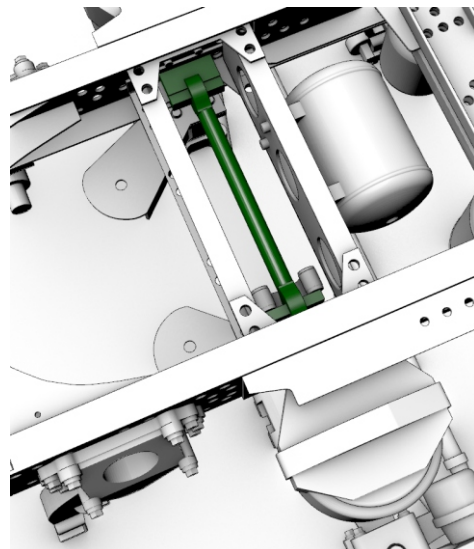

Dutch truck XG+ pusher chassis (4.15). Scale 1/24

79.  x2

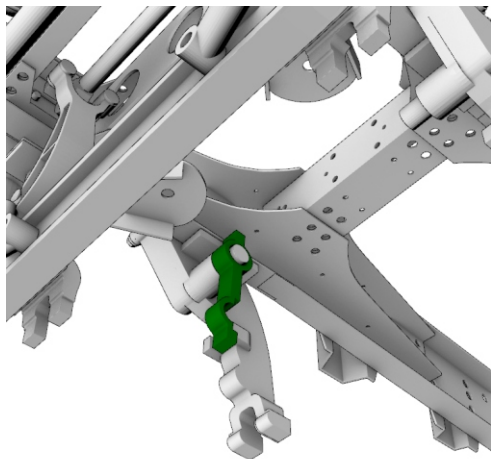

80. 

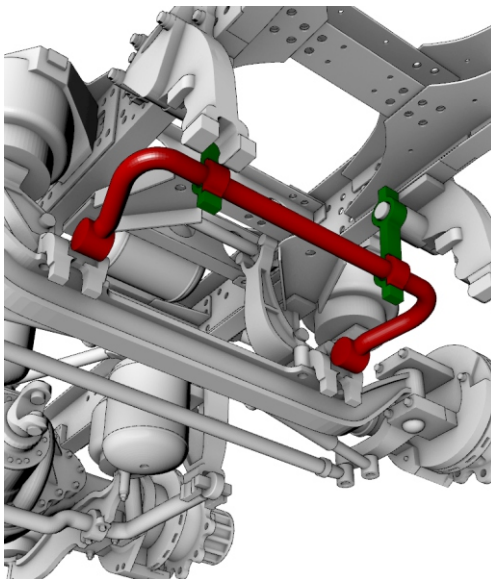

81.  x2

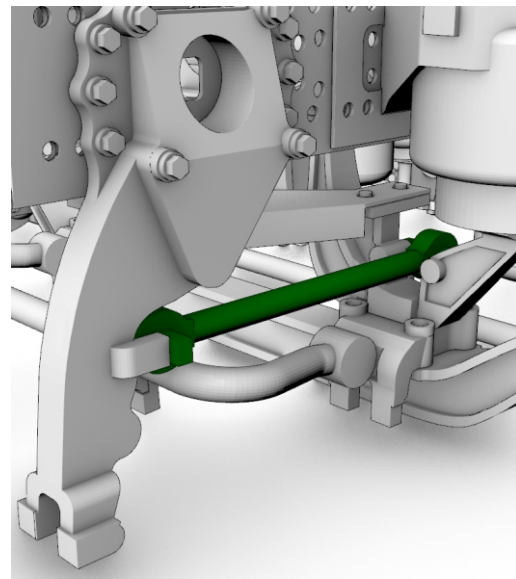

82.  x2

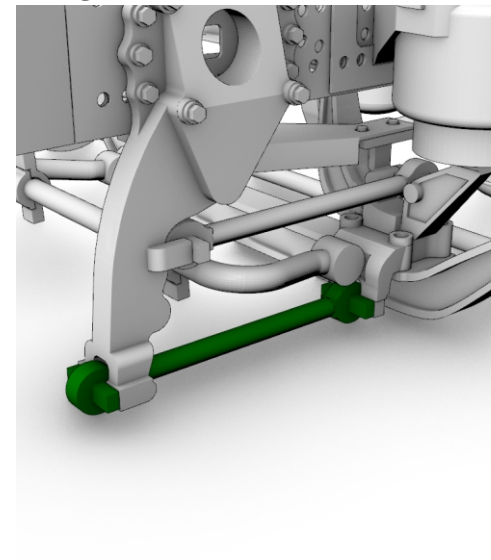

83.  x2

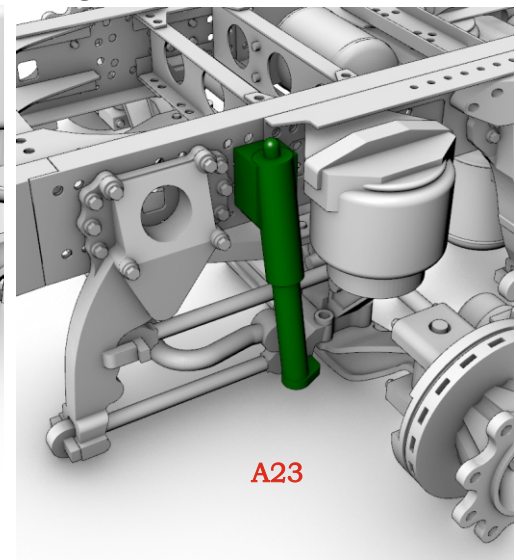

84. 

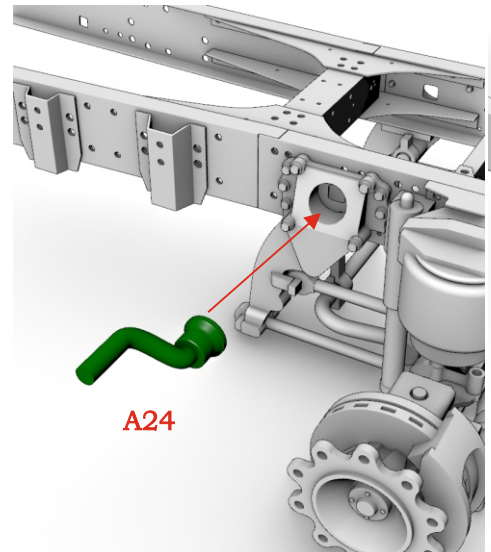

85.  x2

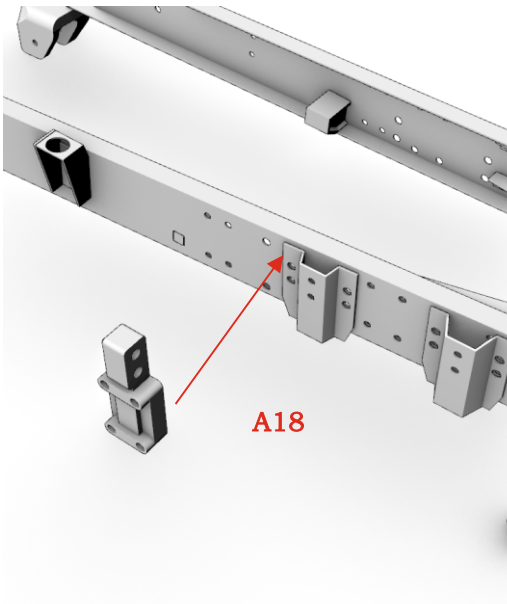

86.  x2

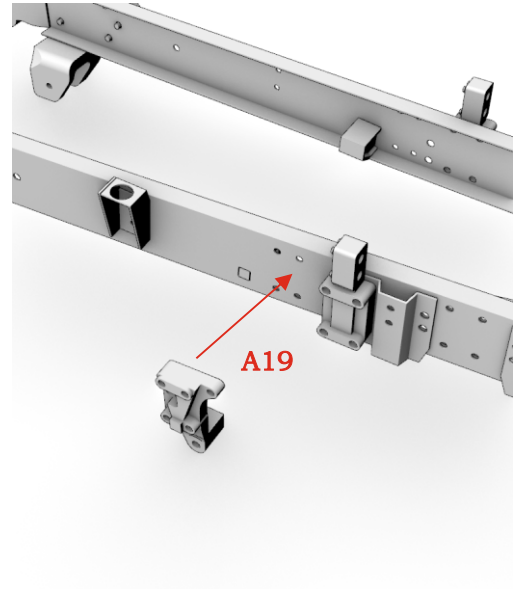

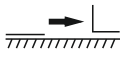

87.  x2  
PE-part #29

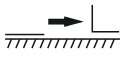

88.  x2  
PE-part #28

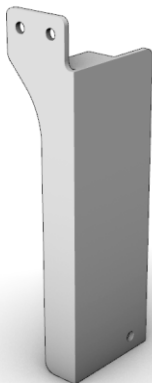

89.  x2

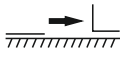

90.    
PE-part #19



91. 

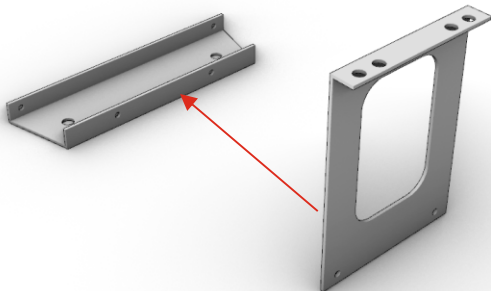

92.  x2

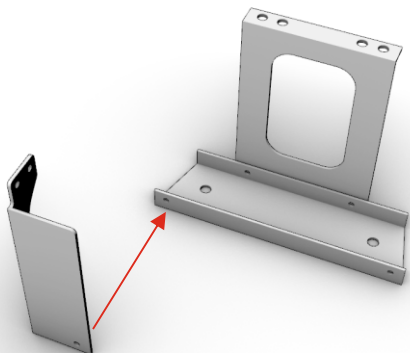

93.  x2

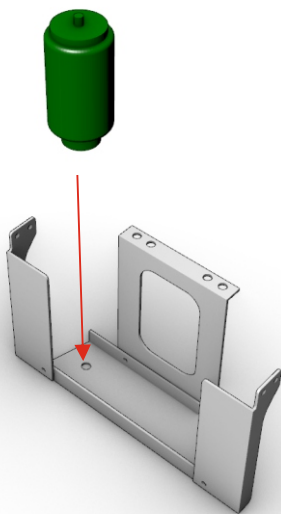

94. 

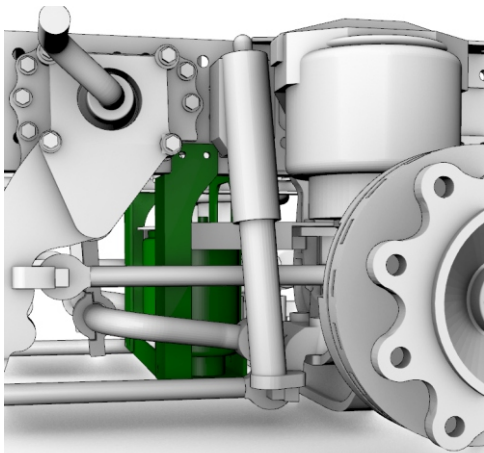
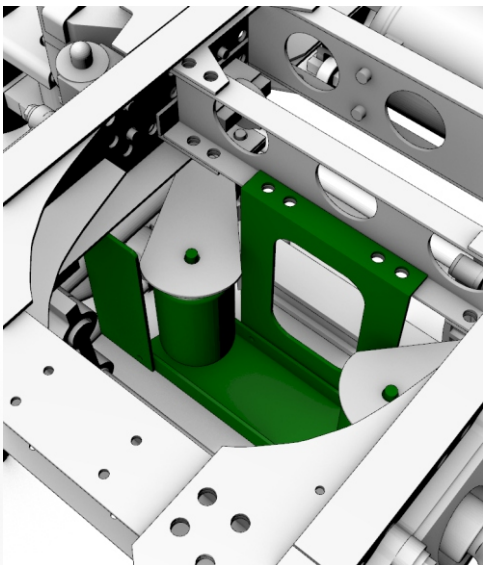

A25

Dutch truck XG+ pusher chassis (4.15). Scale 1/24

95. 🟩 x2

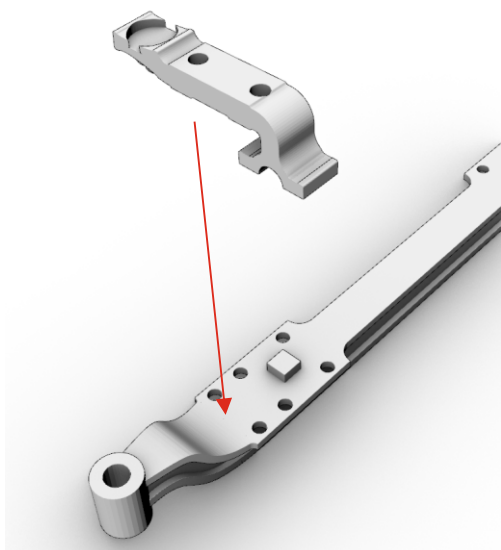

96. 🟩 x2

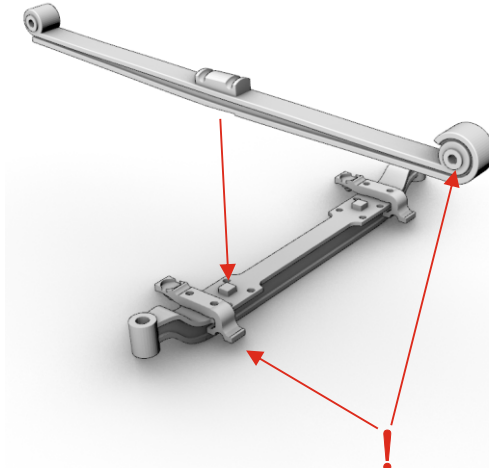

97. 🟩 x2

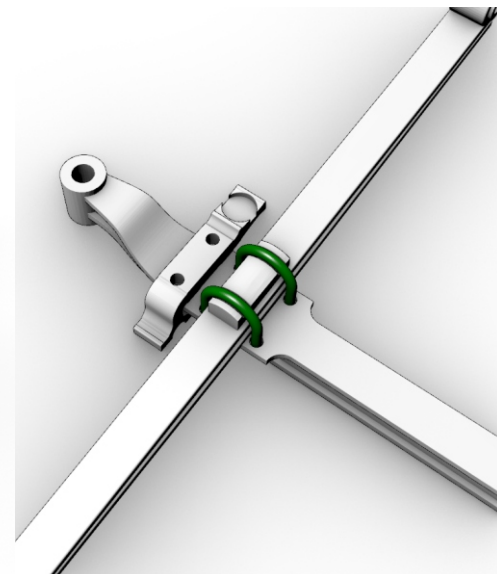

98. 🟩 x2

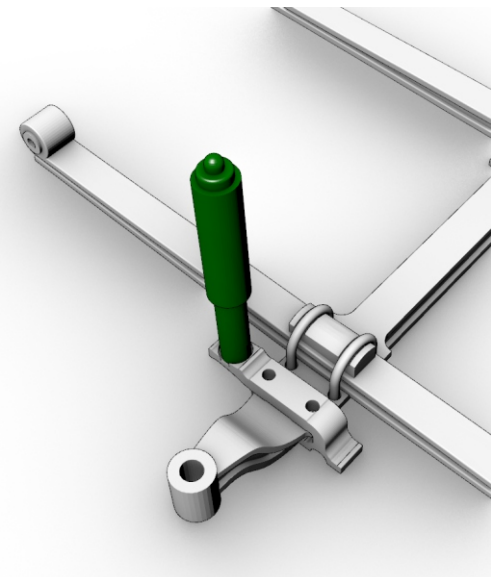

99. 🟩

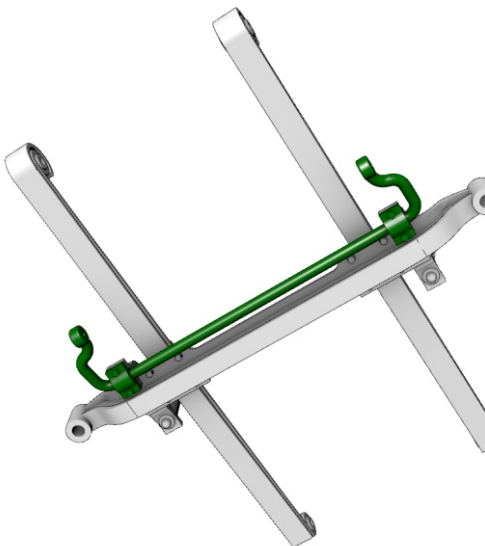

100. 🟩 x2

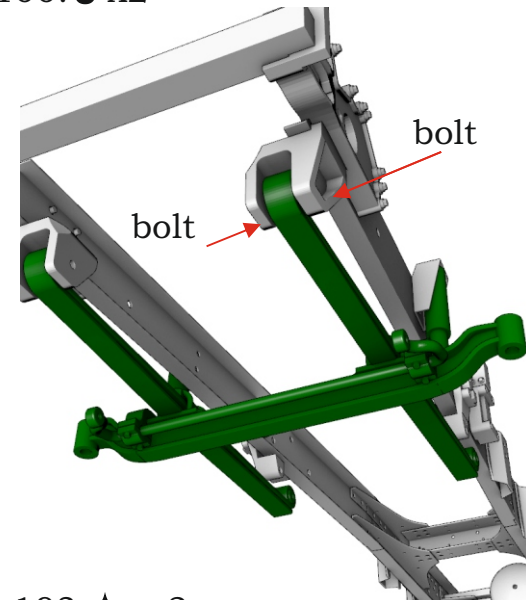

101. 🟩 x2

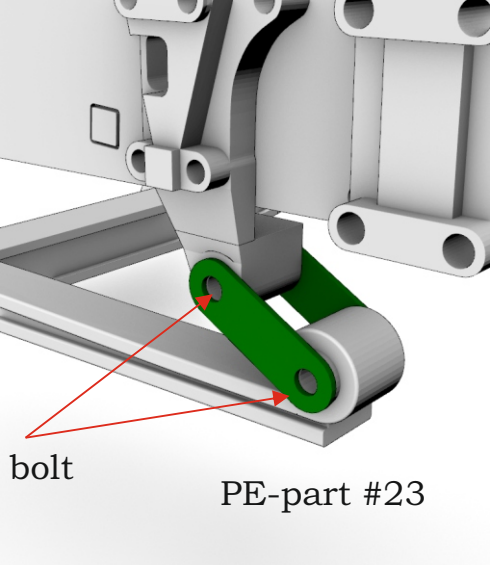

102. 🟩 x2

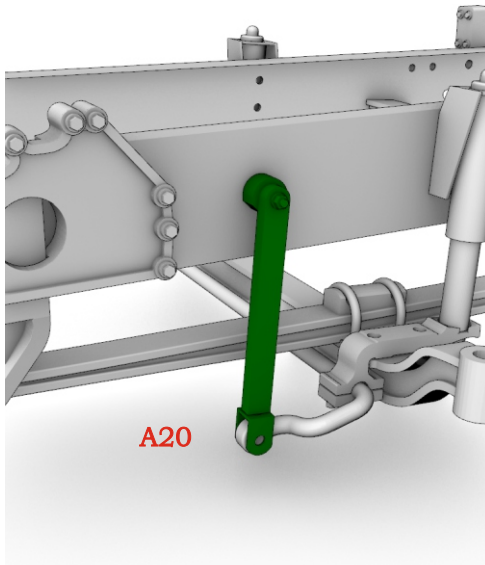

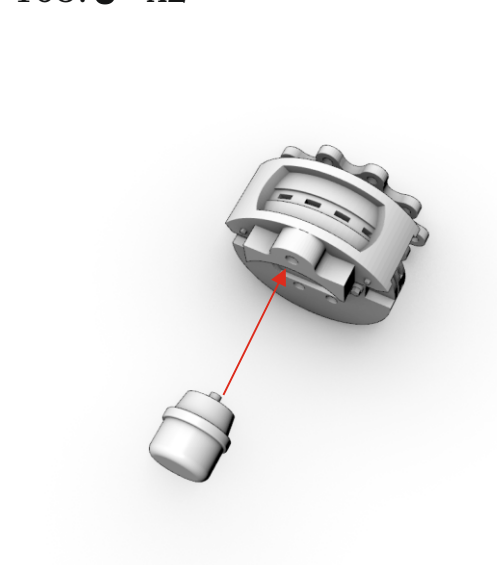

103. 🟩 x2

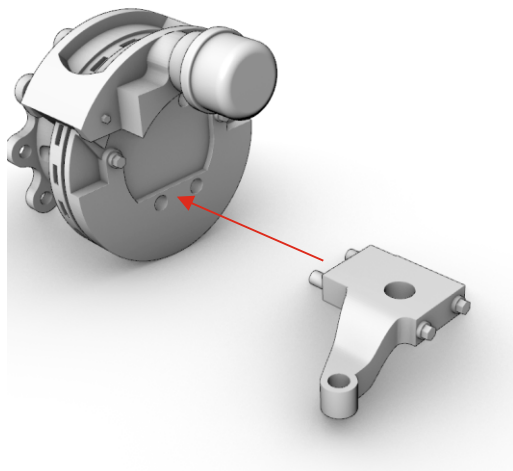

Dutch truck XG+ pusher chassis (4.15). Scale 1/24

104.  x2



105. 

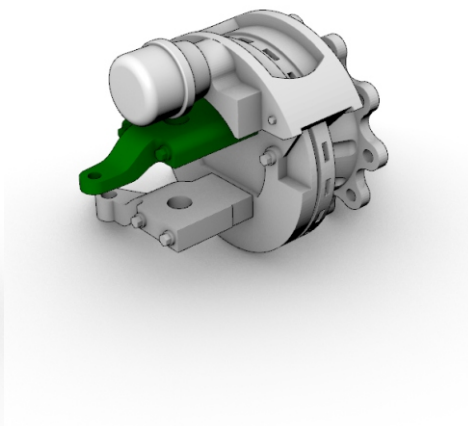

106. 

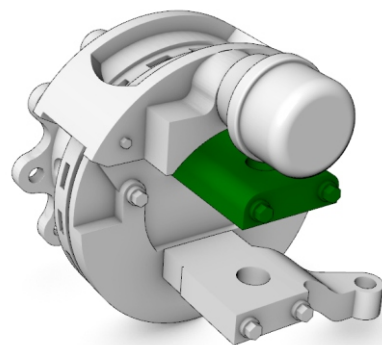

107.  x2

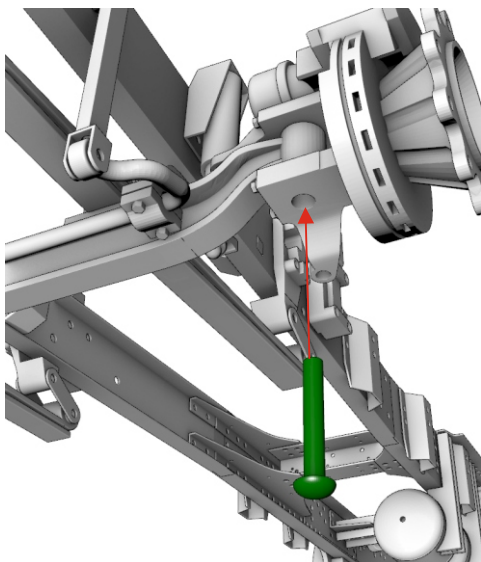

108. 

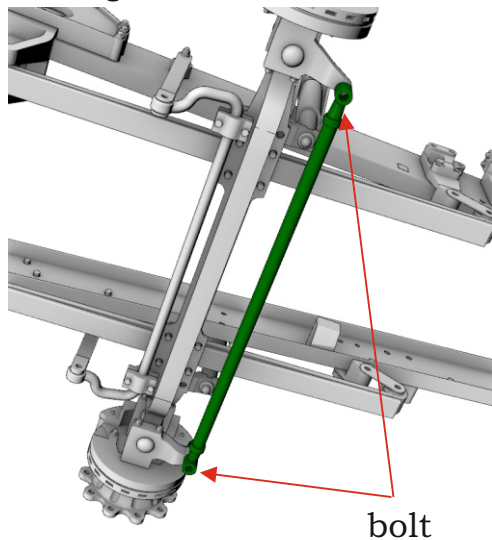

109. 

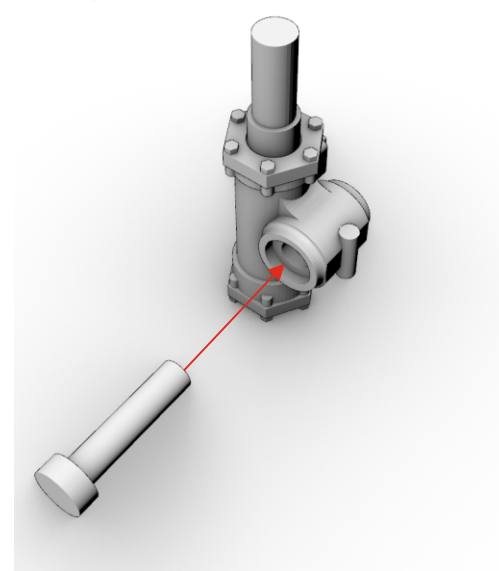

110. 

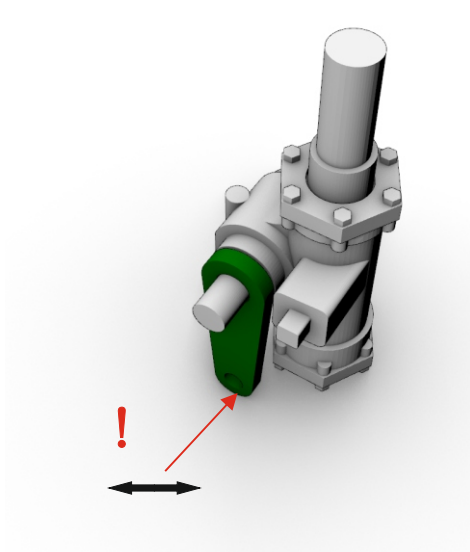

111. 

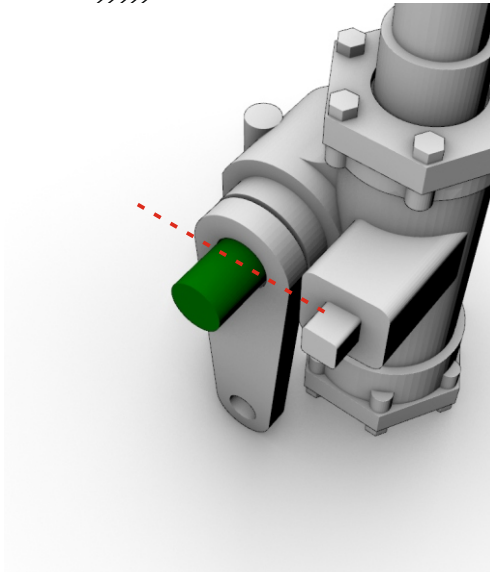

112. 

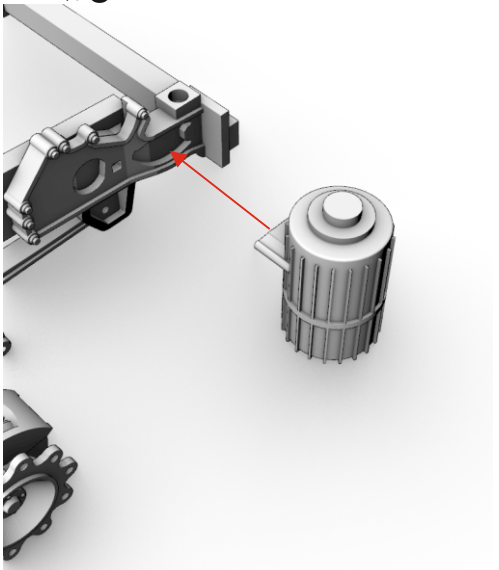



Dutch truck XG+ pusher chassis (4.15). Scale 1/24

113.💧

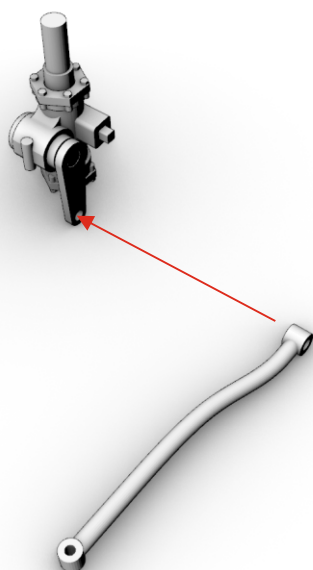

114.💧

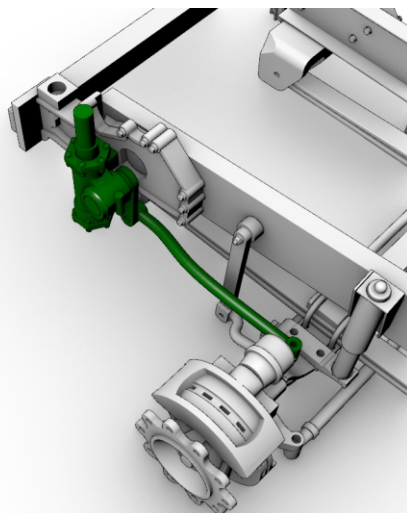

! On the right side  
for RHD chassis

115.💧

A&N Model Trucks  
MX-13 engine shown

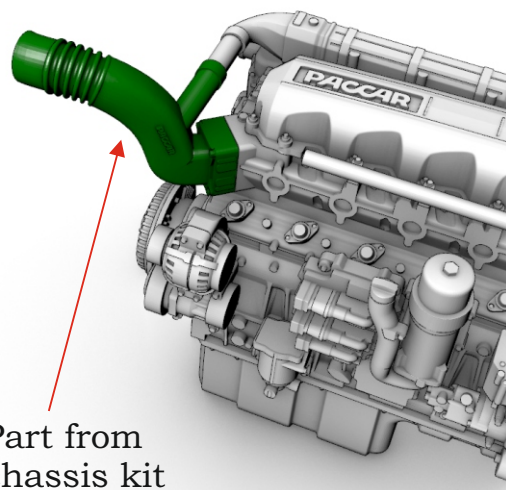

! Part from  
chassis kit

116.💧

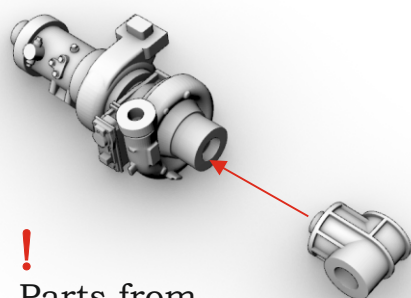

! Parts from  
chassis kit

117.💧

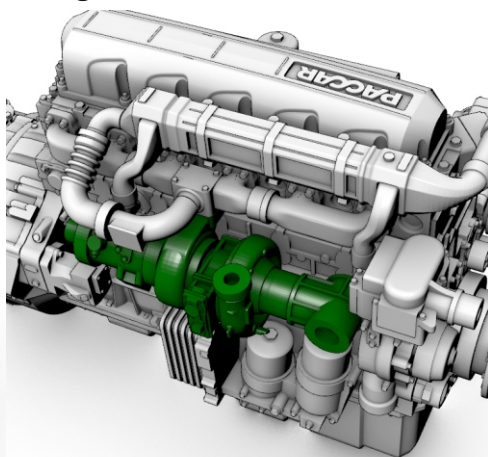

118.💧

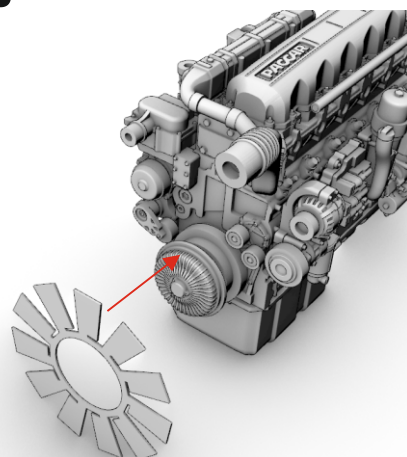

PE-part #34

119.💧

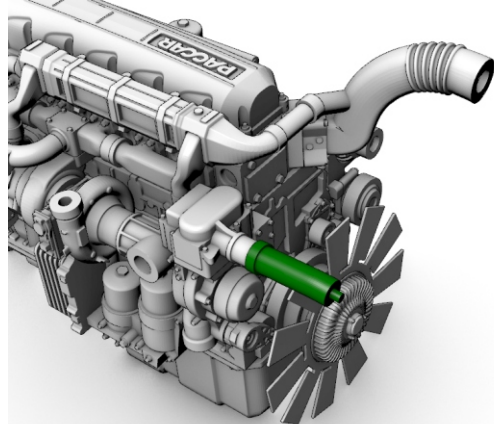

120.💧

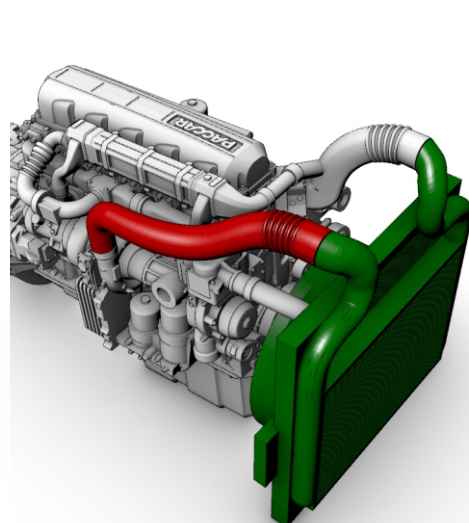

121.💧

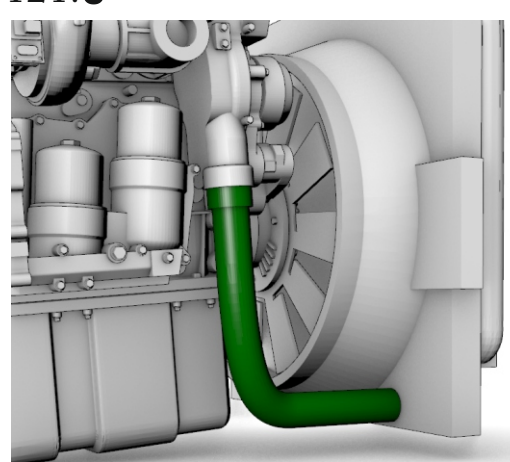



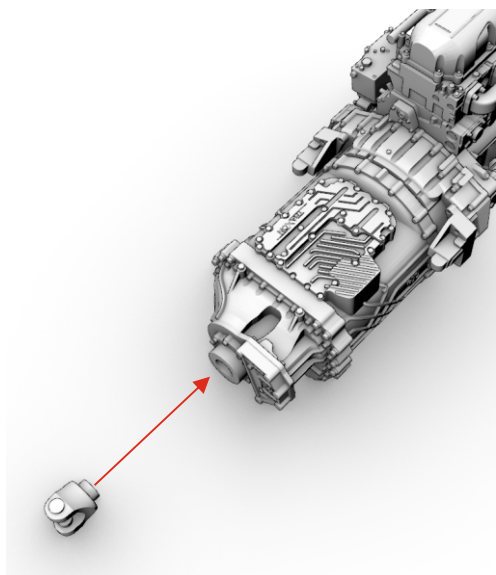

Dutch truck XG+ pusher chassis (4.15). Scale 1/24

122. 

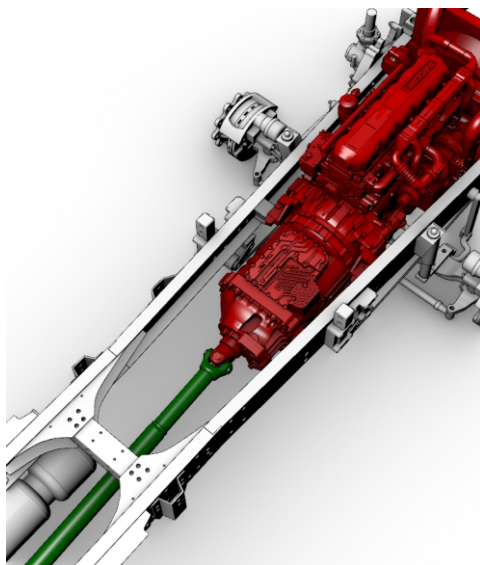

123. 



124. 

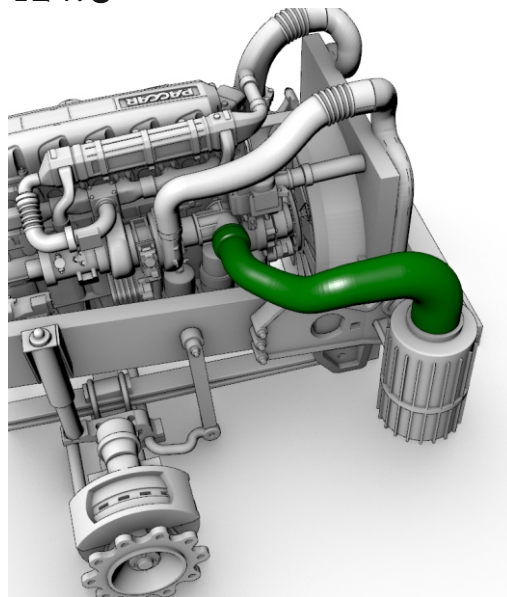

125. 

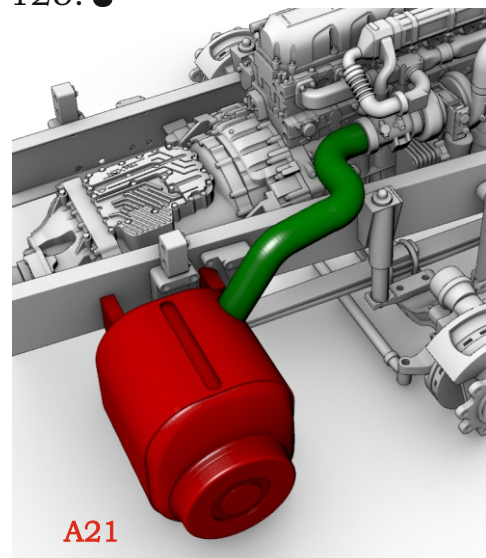

126. 

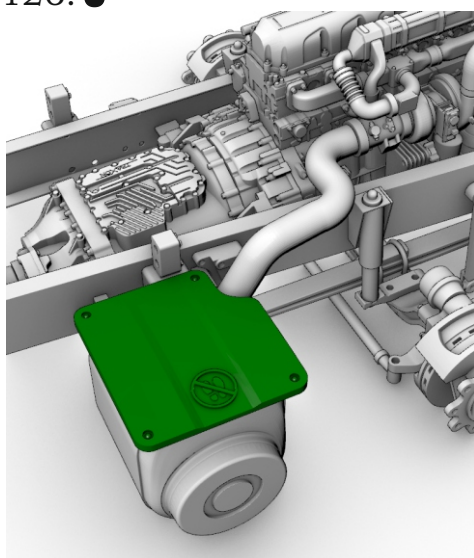

127. 

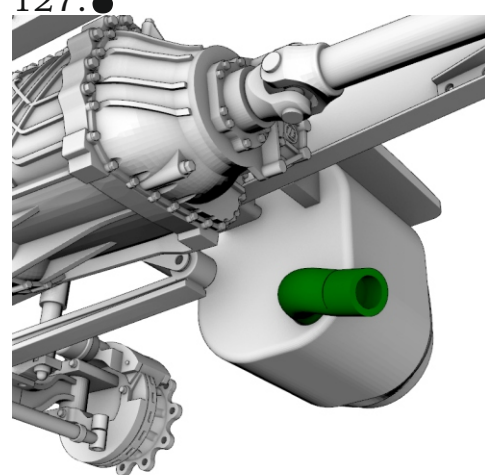

128. 

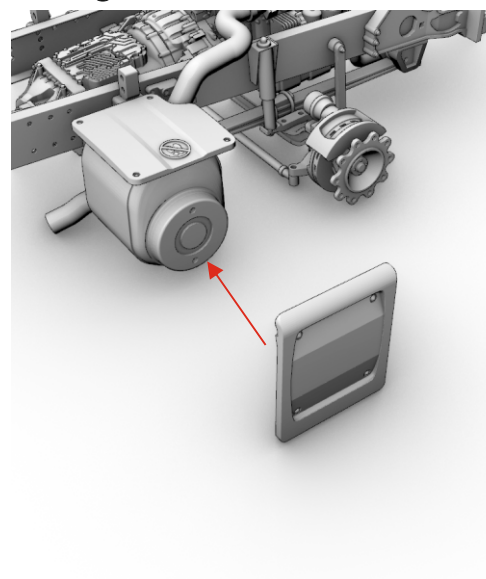

129.  x4

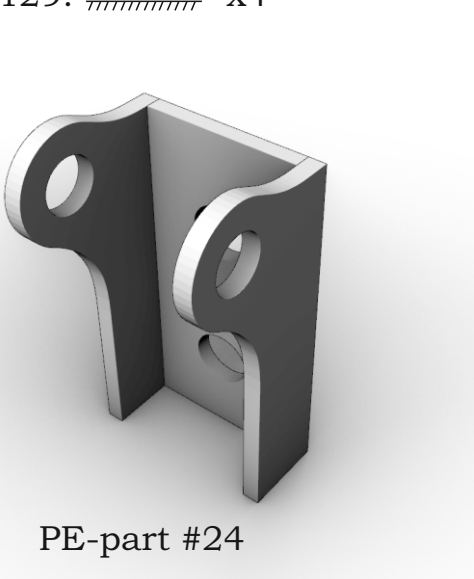

130.  x4

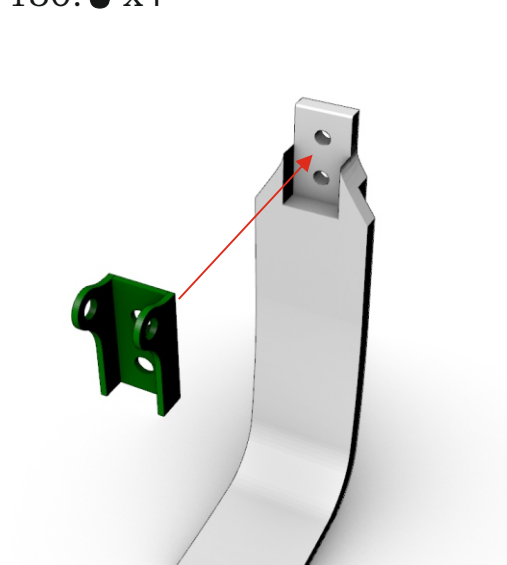

Dutch truck XG+ pusher chassis (4.15). Scale 1/24

130. 🟩 x4

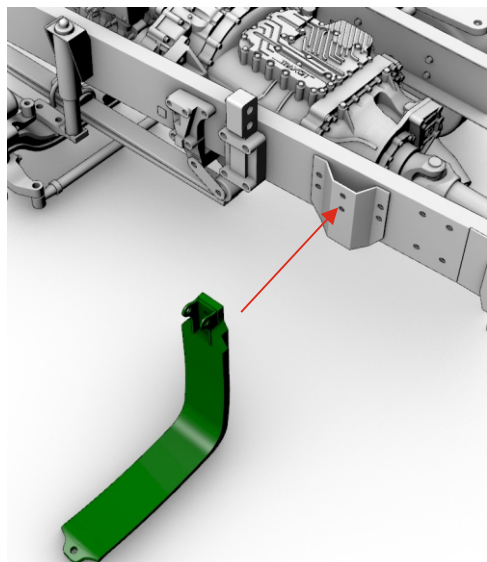

131. ➡️

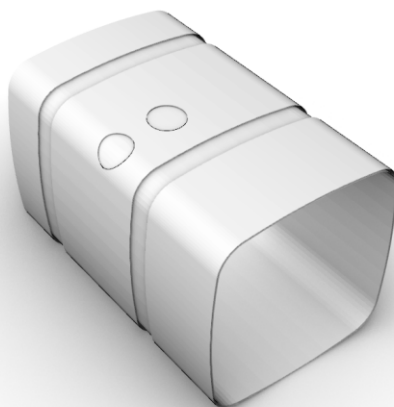

PE-part #32

132. 🟩

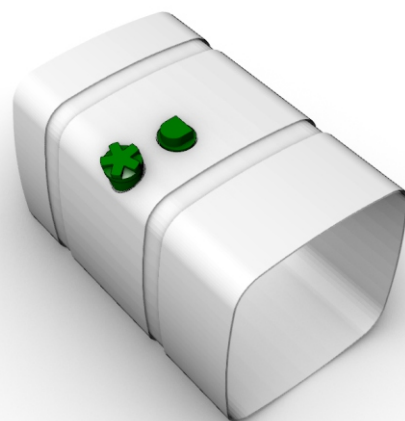

133. 🟩 x2

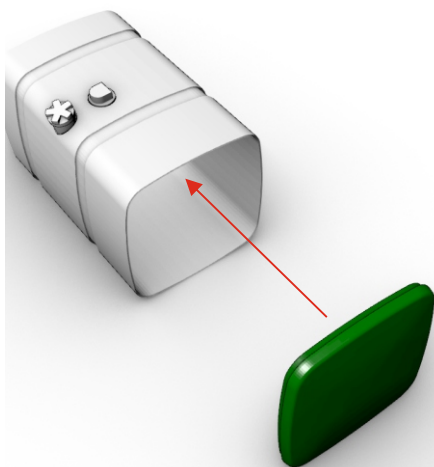

134. 🟩 x4

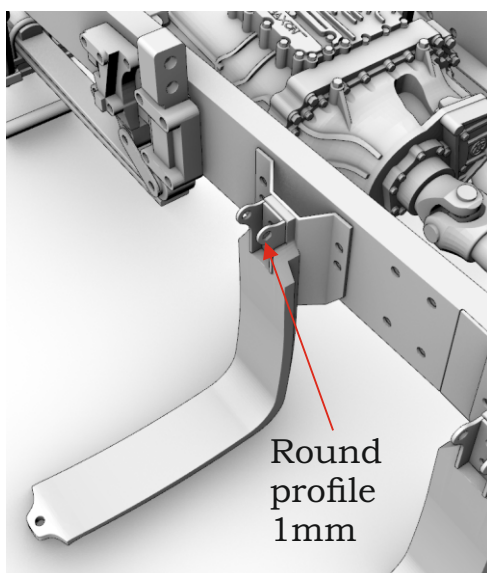

135. ➡️ x4

PE-part #31



136. 🟩

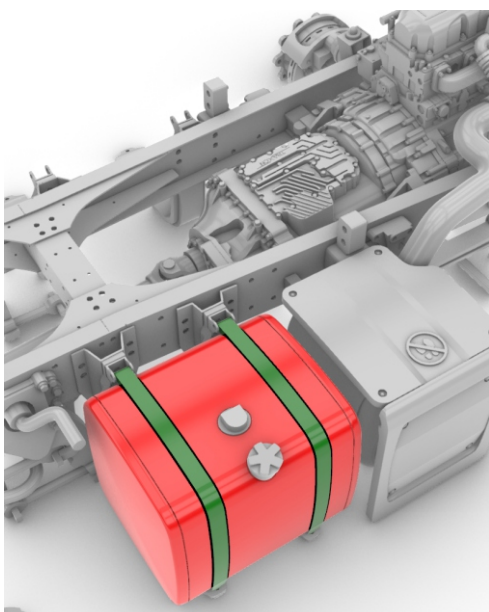

137. ➡️

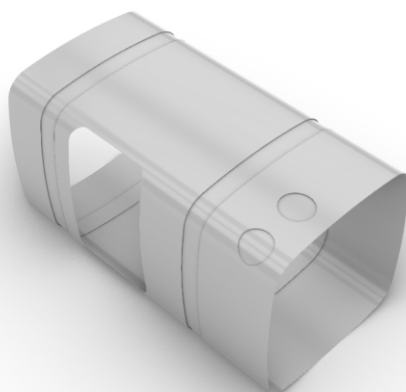

PE-part #33

138. 🟩

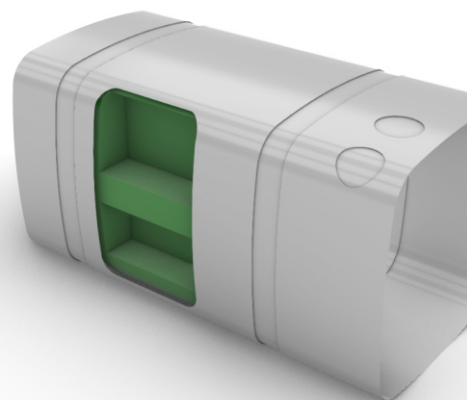



Dutch truck XG+ pusher chassis (4.15). Scale 1/24

139. 滴

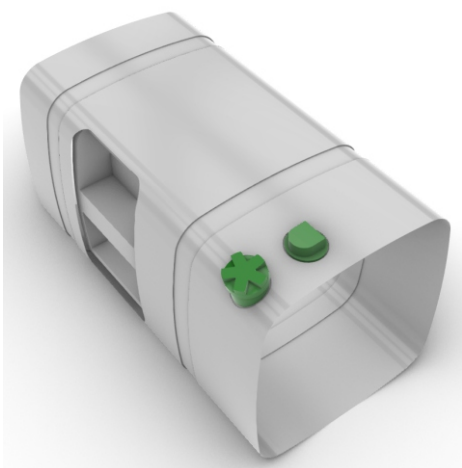

140. 滴

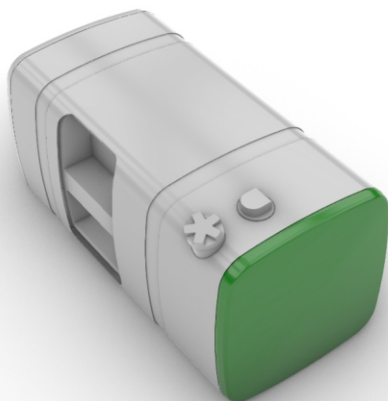

141. 滴

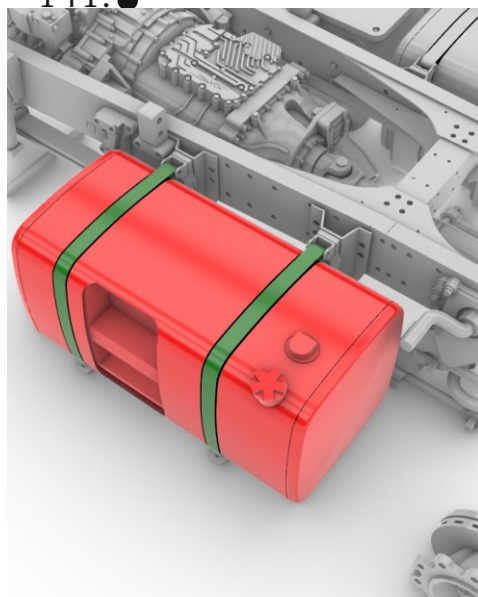

142. 滴 x2

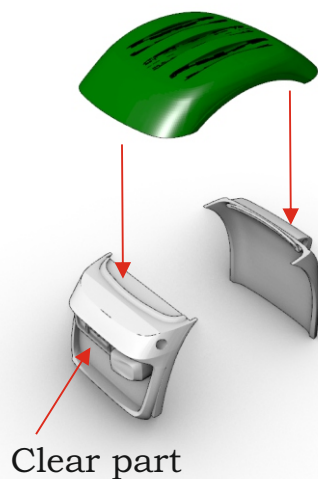

143. 滴 x2

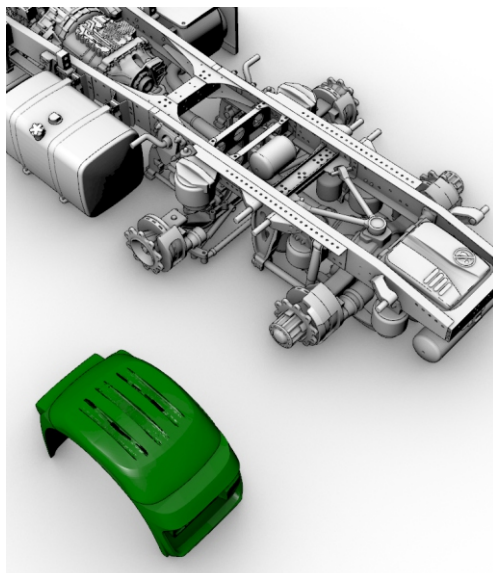

144. 滴 x2

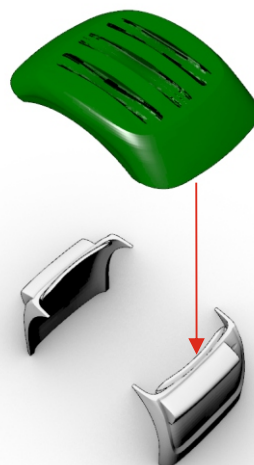

145. 滴 x2

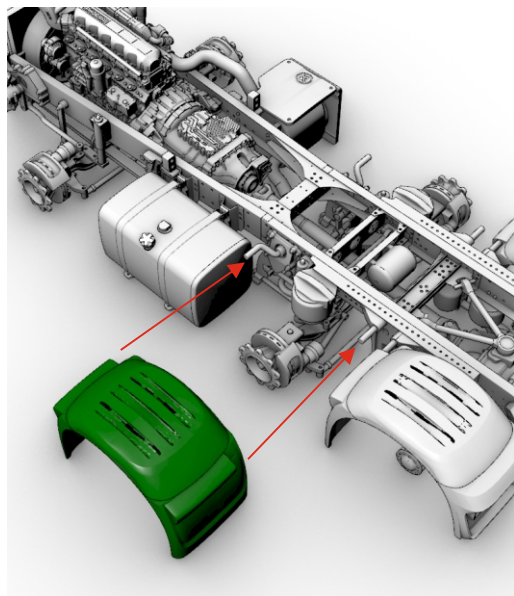

146.

Proceed on steps 65-72  
of Dutch truck XG+  
assembling instruction.

147. 滴

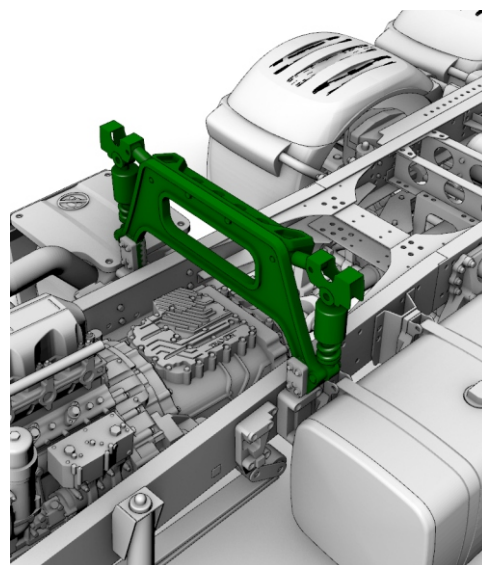

Dutch truck XG+ pusher chassis (4.15). Scale 1/24

148. 🟩

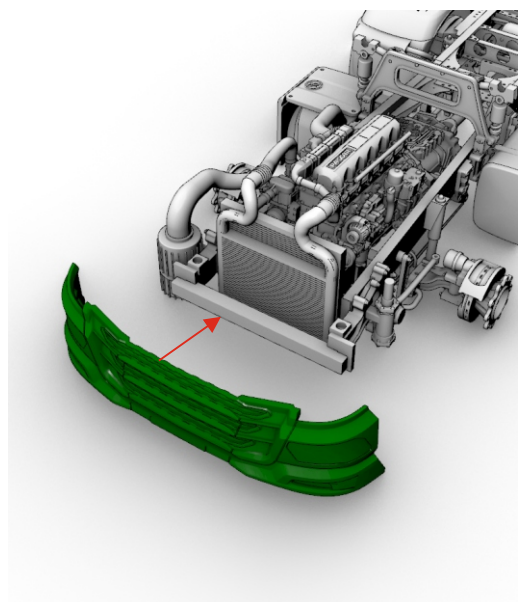

149. 🟩 x2

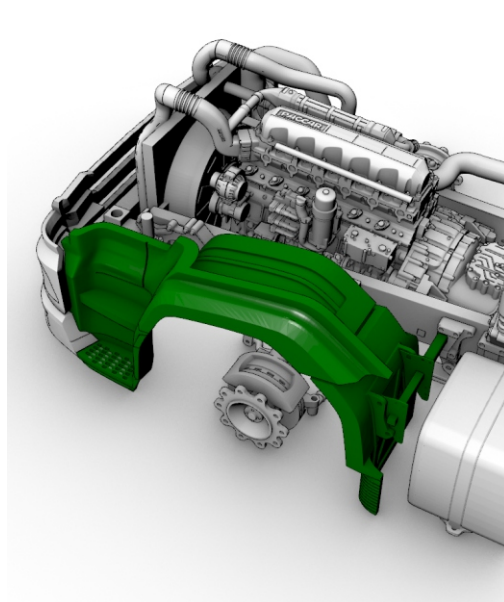

150. 🟩

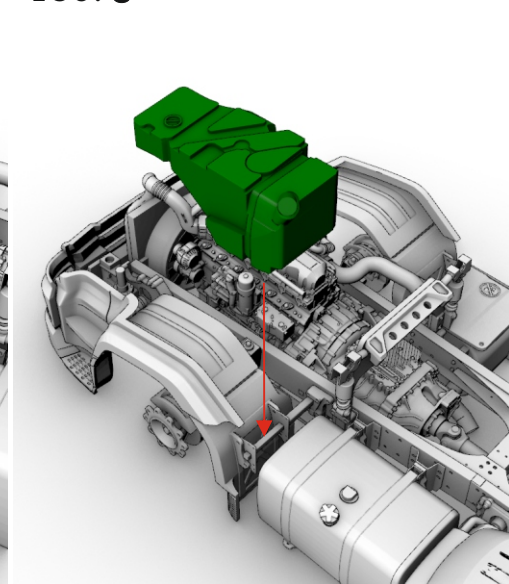

151. 🟩

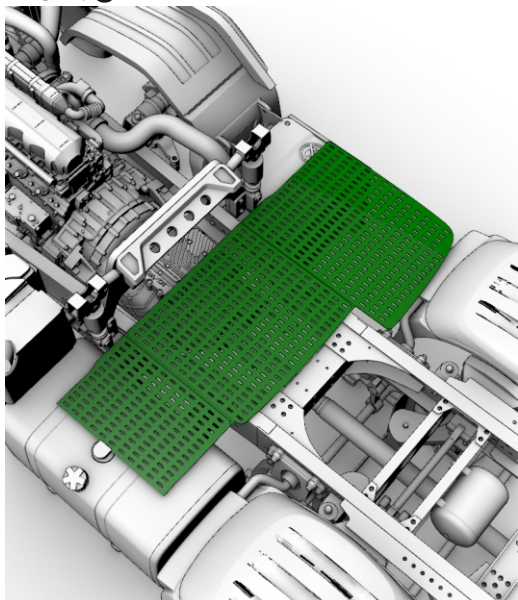

152. 🟩

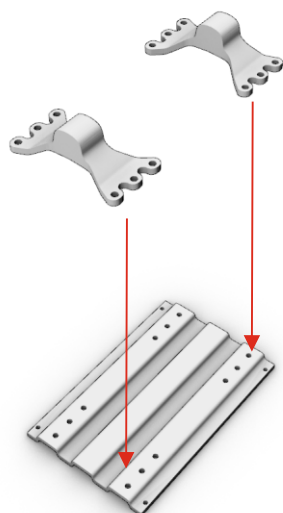

153. 🟩

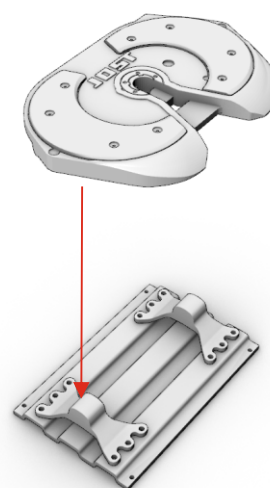

154. 🟩

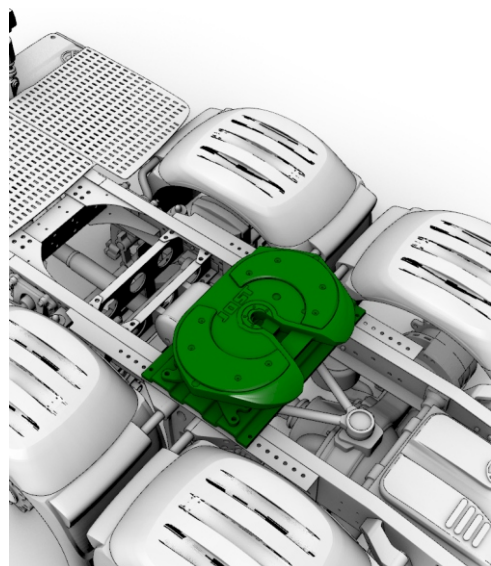

!

If you don't plan to make tilting cab, skip next steps and proceed on step #80 of Dutch truck XG+ assembling instruction.

155. 🟩 x2

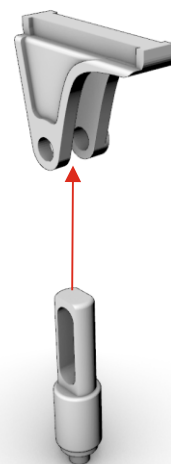



Dutch truck XG+ pusher chassis (4.15). Scale 1/24

156. ✂

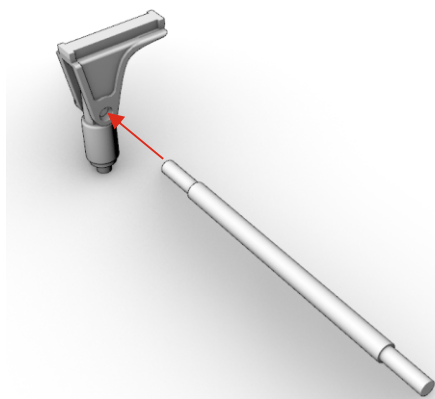

157. ✂

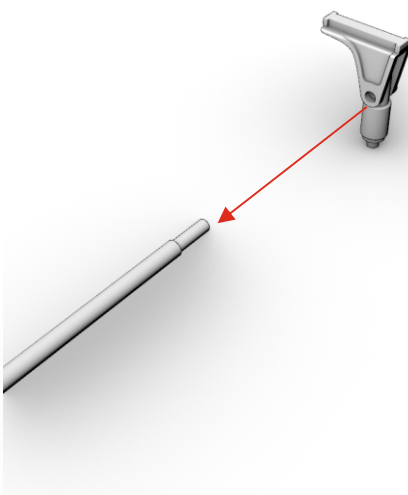

158. ⬇

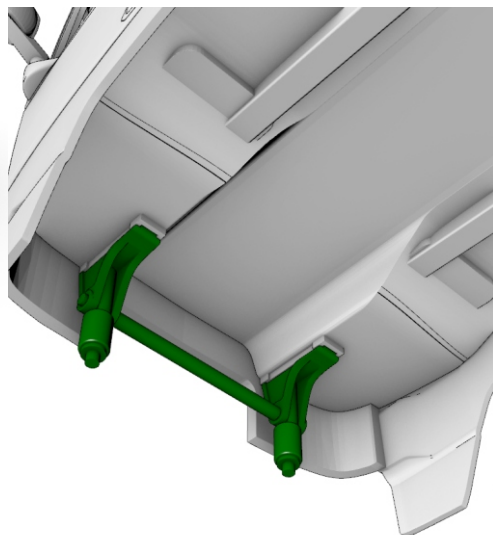

159. ⬇

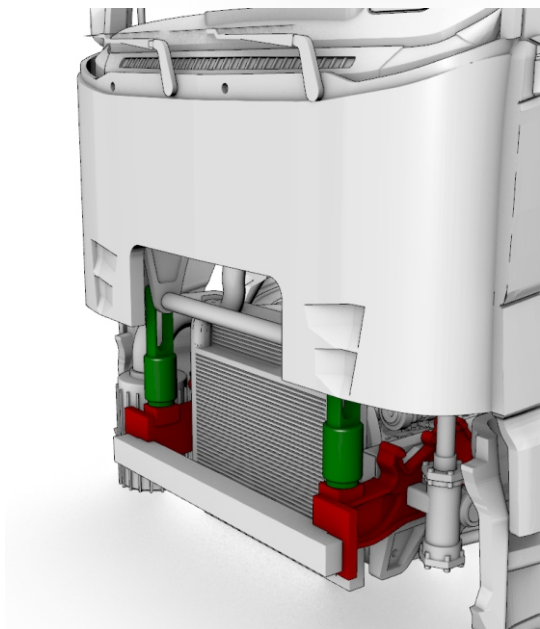

Proceed on step #81  
of Dutch truck XG+  
assembling instruction.